



### 产品特点

- \* 用于快速搬运金属薄板 (循环周期短)。
- \* 搬运金属薄板时不会产生凹陷或变形。
- \* 吸盘底部有特殊凹槽结构, 可防止油性金属板在搬运过程中滑动, 确保工件在压机里精确定位。
- \* 坚固耐磨的扁平吸盘, 采用NBR材质, 单密封唇, 有特殊的凹槽设计和内部支撑结构。
- \* 吸盘有多种连接形式可供选择, 可提供两种材质硬度: 肖氏硬度45和60。

### 型号规格

**MAF** - **30** - **NBR-45** - **G1/4-AG**

①                      ②                      ③                      ④

①产品系列	②吸盘直径	③吸盘硬度	④连接螺纹
MAF - 扁平吸盘	30	NBR-45 - 丁腈橡胶45	G1/4-AG - G1/4外螺纹
	40		G1/4-IG - G1/4内螺纹
	50	NBR-60 - 丁腈橡胶60	G3/8-IG - G3/8内螺纹
	60		M10x1.5-AG - M10外螺纹
	80	M14x1.5-AG - M14外螺纹	
	100	RA - 矩形适配器	

### 性能参数

型号	吸力 (N)	侧向力 (N)	油性表面侧向力 (N)	内部体积 (cm <sup>3</sup> )	工件最小曲率半径 (mm)	推荐软管直径 (mm)
MAF30	38	30	28	1.7	40	4
MAF40	69	52	50	3.8	50	4
MAF50	100	80	76	7.0	65	4
MAF60	150	105	85	13.0	75	6
MAF80	272	205	180	36.0	100	6
MAF100	430	310	300	58.0	135	6

规格尺寸(mm)

•MAF30~100IG(内螺纹)

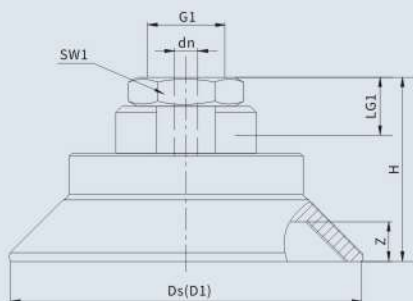

•MAF30~100AG(外螺纹)

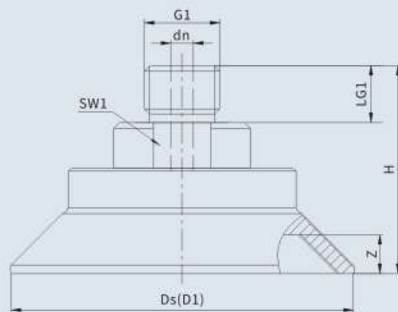

•MAF30~100RA(矩形适配器)

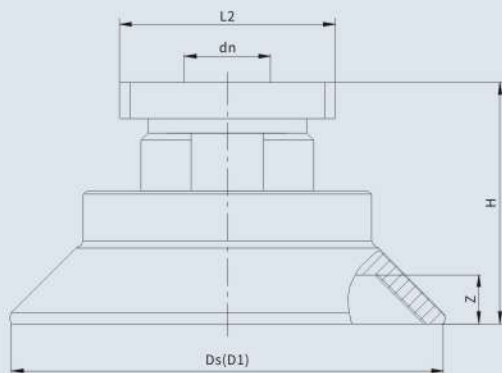

型号	尺寸mm	D1	DN	Ds	G1	H	LG1	L2	SW1	Z
MAF30G1/4-AG		34	4	32	G1/4M	20.0	10	-	17	3.0
MAF30G1/4-IG		34	4	32	G1/4F	20.0	12	-	17	3.0
MAF30G3/8-IG		34	4	32	G3/8F	36.0	9	-	22	3.0
MAF30GM10x1.5-AG		34	4	32	M10x1.5M	20.0	12	-	17	3.0
MAF30GM14x1.5-AG		34	4	32	M14x1.5M	22.0	12	-	17	3.0
MAF30RA		34	4	32	-	23.2	-	32	-	3.0
MAF40G1/4-AG		46	4	42	G1/4M	22.0	10	-	17	4.0
MAF40G1/4-IG		46	4	42	G1/4F	22.0	12	-	17	4.0
MAF40G3/8-IG		46	4	42	G3/8F	38.0	9	-	22	4.0
MAF40GM10x1.5-AG		46	4	42	M10x1.5M	22.0	12	-	17	4.0
MAF40GM14x1.5-AG		46	4	42	M14x1.5M	22.0	12	-	17	4.0
MAF40RA		46	4	42	-	25.0	-	32	-	4.0

**吸盘及组件**

- HXD
- HOP
- HNP
- HNT
- SCG
- HXN
- HGP
- ZP
- ZP3
- ZP3E
- ZP3P
- ZP3P-JT3
- ZP3P-JT5
- MAF**
- MAB
- MAOF
- MAOB
- BK
- PAG
- PATK/PAYK
- PATS
- PAYS
- PATKM/PAYKM
- PCG
- PCTK/PCYK
- PFG
- PFTK/PFYK
- PFTS
- PFYS
- PFTKM/PFYKM
- PJG
- PJTK/PJYK
- PJTS
- PJYS
- PJG
- PS
- PUG
- PUTK/PUYK
- PUTSB/PUYSB

型号	尺寸mm	D1	DN	Ds	G1	H	LG1	L2	SW1	Z
MAF50G1/4-AG		56	6	52	G1/4M	28.0	10	-	22	5.0
MAF50G1/4-IG		56	6	52	G1/4F	33.0	15	-	22	5.0
MAF50G3/8-IG		56	6	52	G3/8F	28.0	15	-	22	5.0
MAF50GM10x1.5-AG		56	4	52	M10x1.5M	28.0	12	-	22	5.0
MAF50GM14x1.5-AG		56	6	52	M14x1.5M	28.0	12	-	22	5.0
MAF50RA		56	6	52	-	27.5	-	32	-	5.0
MAF60G1/4-AG		67	6	63	G1/4M	31.0	10	-	22	6.0
MAF60G1/4-IG		67	6	63	G1/4F	36.0	15	-	22	6.0
MAF60G3/8-IG		67	6	63	G3/8F	31.0	15	-	22	6.0
MAF60GM10x1.5-AG		67	4	63	M10x1.5M	31.0	12	-	22	6.0
MAF60GM14x1.5-AG		67	6	63	M14x1.5M	31.0	12	-	22	6.0
MAF60RA		67	6	63	-	30.5	-	32	-	6.0
MAF80G1/4-AG		89	6	83	G1/4M	35.0	10	-	22	7.6
MAF80G1/4-IG		89	6	83	G1/4F	40.0	20	-	22	7.6
MAF80G3/8-IG		89	6	83	G3/8F	35.0	15	-	22	7.6
MAF80GM10x1.5-AG		89	4	83	M10x1.5M	35.0	12	-	22	7.6
MAF80GM14x1.5-AG		89	6	83	M14x1.5M	35.0	12	-	22	7.6
MAF80RA		89	6	83	-	34.5	-	32	-	7.6
MAF100G1/4-AG		110	6	103	G1/4M	36.0	10	-	22	9.5
MAF100G1/4-IG		110	6	103	G1/4F	41.0	20	-	22	9.5
MAF100G3/8-IG		110	6	103	G3/8F	36.0	15	-	22	9.5
MAF100GM10x1.5-AG		110	4	103	M10x1.5M	36.0	12	-	22	9.5
MAF100GM14x1.5-AG		110	6	103	M14x1.5M	36.0	12	-	22	9.5
MAF100RA		110	6	103	-	35.5	-	32	-	9.5



### 产品特点

- \*用于快速搬运金属薄板(循环周期短)。
- \*搬运金属薄板时不会产生凹陷或变形。
- \*吸盘底部有特殊凹槽结构,可防止油性金属板在搬运过程中滑动,确保工件在压机里精确定位。
- \*坚固耐磨的1.5折波纹吸盘,采用NBR材质,单密封唇,有特殊的凹槽设计和内部支撑结构。
- \*吸盘有多种连接形式可供选择,可提供两种材质硬度:肖氏硬度45和60。

### 型号规格

**MAB** - **30** - **NBR-60** - **G1/4-AG**

①                      ②                      ③                      ④

①产品系列	②吸盘直径	③吸盘硬度	④连接螺纹
MAB-波纹吸盘	30	NBR-60-丁腈橡胶60	G1/4-AG - G1/4外螺纹
	40		G1/4-IG - G1/4内螺纹
	50		G3/8-IG - G3/8内螺纹
	60		M10x1.5-AG - M10外螺纹
	80		M14x1.5-AG - M14外螺纹
	100		RA - 矩形适配器

### 性能参数

型号	吸力(N)	拉脱力(N)	侧向力(N)	油性表面侧向力(N)	内部体积(cm <sup>3</sup> )	工件最小曲率半径(mm)	推荐软管直径(mm)
MAB30	22	33	30	13	5.9	40	4
MAB40	38	59	36	33	7.0	40	4
MAB50	53	87	55	52	11.5	50	4
MAB60	82	130	82	77	24.0	65	6
MAB80	135	221	145	140	56.5	75	6
MAB100	190	357	220	214	92.5	90	6

**吸盘及组件**

- HXD
- HOP
- HNP
- HNT
- SCG
- HXN
- HGP
- ZP
- ZP3
- ZP3E
- ZP3P
- ZP3P-JT3
- ZP3P-JT5
- MAF
- MAB**
- MAOF
- MAOB
- BK
- PAG
- PATK/PAYK
- PATS
- PAYS
- PATKM/PAYKM
- PCG
- PCTK/PCYK
- PFG
- PFTK/PFYK
- PFTS
- PFYS
- PFTKM/PFYKM
- PJG
- PJTK/PJYK
- PJTS
- PJYS
- PJG
- PS
- PUG
- PUTK/PUYK
- PUTSB/PUYSB

**规格尺寸(mm)**

•MAB30~100IG(内螺纹)

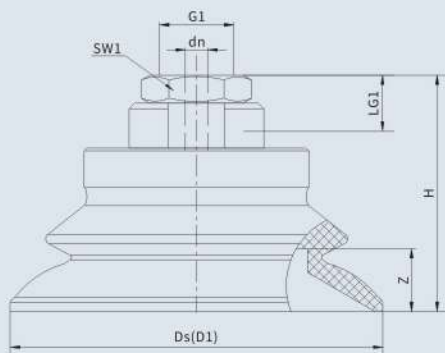

•MAB30~100AG(外螺纹)

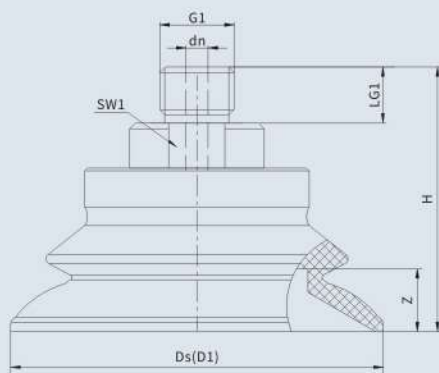

•MAB30~100RA(矩形适配器)

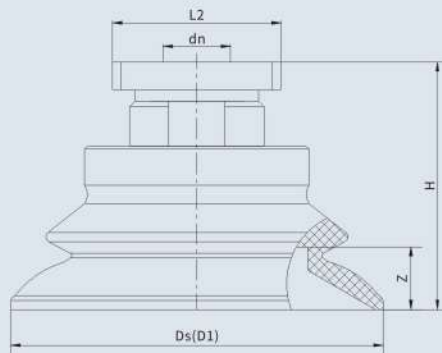

型号	尺寸mm	D1	DN	Ds	G1	H	LG1	L2	SW1	Z
MAB30G1/4-AG		34	4	32	G1/4M	28.0	10	-	17	9.0
MAB30G1/4-IG		34	4	32	G1/4F	28.0	12	-	17	9.0
MAB30G3/8-IG		34	4	32	G3/8F	44.0	9.5	-	22	9.0
MAB30GM10x1.5-AG		34	4	32	M10x1.5M	28.0	12	-	17	9.0
MAB30GM14x1.5-AG		34	4	32	M14x1.5M	28.0	12	-	17	9.0
MAB30RA		34	4	32	-	31.2	-	32	-	9.0
MAB40G1/4-AG		45	4	42	G1/4M	29.0	10	-	17	10.0
MAB40G1/4-IG		45	4	42	G1/4F	29.0	12	-	17	10.0
MAB40G3/8-IG		45	4	42	G3/8F	44.0	9.5	-	22	10.0
MAB40GM10x1.5-AG		45	4	42	M10x1.5M	29.0	12	-	17	10.0
MAB40GM14x1.5-AG		45	4	42	M14x1.5M	29.0	12	-	17	10.0
MAB40RA		45	4	42	-	31.2	-	32	-	10.0

型号	尺寸mm	D1	DN	DS	G1	H	LG1	L2	SW1	Z
MAB50G1/4-AG		56	6	52	G1/4M	37.0	10	-	22	11.5
MAB50G1/4-IG		56	6	52	G1/4F	42.0	20	-	22	11.5
MAB50G3/8-IG		56	6	52	G3/8F	37.0	15	-	22	11.5
MAB50GM10x1.5-AG		56	4	52	M10x1.5M	37.0	12	-	22	11.5
MAB50GM14x1.5-AG		56	6	52	M14x1.5M	37.0	12	-	22	11.5
MAB50RA		56	6	52	-	36.5	-	32	-	11.5
MAB60G1/4-AG		67	6	63	G1/4M	41.5	10	-	22	14.5
MAB60G1/4-IG		67	6	63	G1/4F	46.5	20	-	22	14.5
MAB60G3/8-IG		67	6	63	G3/8F	41.5	15	-	22	14.5
MAB60GM10x1.5-AG		67	4	63	M10x1.5M	41.5	12	-	22	14.5
MAB60GM14x1.5-AG		67	6	63	M14x1.5M	41.5	12	-	22	14.5
MAB60RA		67	6	63	-	41.0	-	32	-	14.5
MAB80G1/4-AG		89	6	83	G1/4M	50.0	10	-	22	22.0
MAB80G1/4-IG		89	6	83	G1/4F	55.0	20	-	22	22.0
MAB80G3/8-IG		89	6	83	G3/8F	50.0	15	-	22	22.0
MAB80GM10x1.5-AG		89	4	83	M10x1.5M	50.0	12	-	22	22.0
MAB80GM14x1.5-AG		89	6	83	M14x1.5M	50.0	12	-	22	22.0
MAB80RA		89	6	83	-	49.5	-	32	-	22.0
MAB100G1/4-AG		110	6	103	G1/4M	57.0	10	-	22	26.0
MAB100G1/4-IG		110	6	103	G1/4F	62.0	20	-	22	26.0
MAB100G3/8-IG		110	6	103	G3/8F	57.0	15	-	22	26.0
MAB100GM10x1.5-AG		110	4	103	M10x1.5M	57.0	12	-	22	26.0
MAB100GM14x1.5-AG		110	6	103	M14x1.5M	57.0	12	-	22	26.0
MAB100RA		110	6	103	-	56.5	-	32	-	26.0

吸盘及组件

HXD  
HOP  
HNP  
HNT  
SCG  
HXN  
HGP  
ZP  
ZP3  
ZP3E  
ZP3P  
ZP3P-JT3  
ZP3P-JT5  
MAF  
**MAB**  
MAOF  
MAOB  
BK  
PAG  
PATK/PAYK  
PATS  
PAYS  
PATKM/PAYKM  
PCG  
PCTK/PCYK  
PFG  
PFTK/PFYK  
PFTS  
PFYS  
PFTKM/PFYKM  
PJG  
PJTK/PJYK  
PJTS  
PJYS  
PJG  
PS  
PUG  
PUTK/PUYK  
PUTSB/PUYSB





## 规格尺寸(mm)

•MAOF50x16~120x60 (内螺纹)

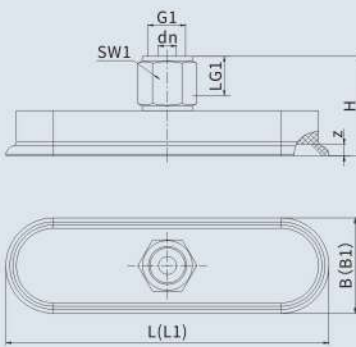

•MAOF50x16~120x60 (外螺纹)

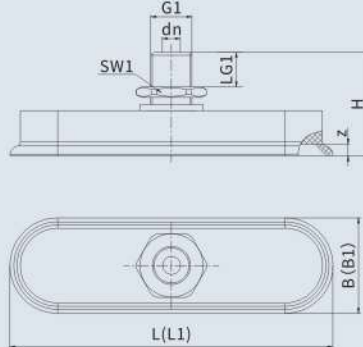

•MAOF50x16~120x60RA (矩形适配器)

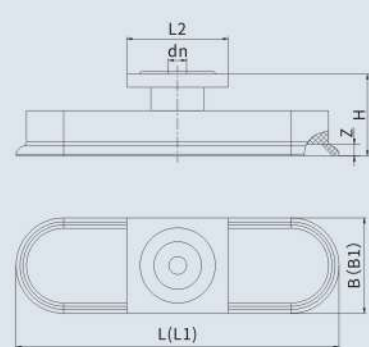

型号	尺寸mm	B	B1	dn	G1	H	L	L1	L2	LG1	SW1	Z
MAOF50x16G1/4-AG		16	18	5	G1/4M	26	50	51.5	-	8	17	3
MAOF50x16G1/4-IG		16	18	6	G1/4F	33	50	51.5	-	8	17	3
MAOF50x16G3/8-IG		16	18	6	G3/8F	34	50	51.5	-	9	22	3
MAOF50x16M10x1.5-AG		16	18	4	M10x1.5M	26	50	51.5	-	10	16	3
MAOF50x16M14x1.5-AG		16	18	5	M14x1.5M	28	50	51.5	-	10	22	3
MAOF50x16RA		16	18	4	-	29	50	51.5	32	-	-	3
MAOF60x23G1/4-AG		23	25	5	G1/4M	18	62	64	-	8	17	3
MAOF60x23G1/4-IG		23	25	6	G1/4F	26	62	64	-	8	17	3
MAOF60x23G3/8-IG		23	25	6	G3/8F	26	62	64	-	9	22	3
MAOF60x23M10x1.5-AG		23	25	4	M10x1.5M	18	62	64	-	10	16	3
MAOF60x23M14x1.5-AG		23	25	5	M14x1.5M	20	62	64	-	10	22	3
MAOF60x23RA		23	25	4	-	21	62	64	32	-	-	3
MAOF90x30G1/4-AG		32	34	5	G1/4M	19	92	94	-	8	17	3
MAOF90x30G1/4-IG		32	34	6	G1/4F	26	92	94	-	8	17	3
MAOF90x30G3/8-IG		32	34	6	G3/8F	27	92	94	-	9	22	3
MAOF90x30M10x1.5-AG		32	34	4	M10x1.5M	19	92	94	-	10	16	3
MAOF90x30M14x1.5-AG		32	34	5	M14x1.5M	21	92	94	-	10	22	3
MAOF90x30RA		32	34	4	-	22	92	94	32	-	-	3
MAOF80x40G1/4-AG		40	43	5	G1/4M	20	82	85	-	8	17	4
MAOF80x40G1/4-IG		40	43	6	G1/4F	28	82	85	-	8	17	4
MAOF80x40G3/8-IG		40	43	6	G3/8F	28	82	85	-	9	22	4
MAOF80x40M10x1.5-AG		40	43	4	M10x1.5M	20	82	85	-	10	16	4
MAOF80x40M14x1.5-AG		40	43	5	M14x1.5M	22	82	85	-	10	22	4
MAOF80x40RA		40	43	4	-	23	82	85	32	-	-	4
MAOF100x50G1/4-AG		50	54	6	G1/4M	22	102	106	-	8	17	5
MAOF100x50G1/4-IG		50	54	8	G1/4F	30	102	106	-	8	17	5
MAOF100x50G3/8-IG		50	54	8	G3/8F	31	102	106	-	9	22	5
MAOF100x50M10x1.5-AG		50	54	4	M10x1.5M	22	102	106	-	10	16	5
MAOF100x50M14x1.5-AG		50	54	6	M14x1.5M	24	102	106	-	10	22	5
MAOF100x50RA		50	54	6	-	25	102	106	32	-	-	5
MAOF120x60G1/4-AG		60	65	6	G1/4M	24	123	128	-	8	17	6
MAOF120x60G1/4-IG		60	65	8	G1/4F	32	123	128	-	8	17	6
MAOF120x60G3/8-IG		60	65	8	G3/8F	33	123	128	-	9	22	6
MAOF120x60M10x1.5-AG		60	65	4	M10x1.5M	24	123	128	-	10	16	6
MAOF120x60M14x1.5-AG		60	65	6	M14x1.5M	26	123	128	-	10	22	6
MAOF120x60RA		60	65	6	-	27	123	128	32	-	-	6





## 规格尺寸(mm)

•MAOB60x30~110x55 (内螺纹)

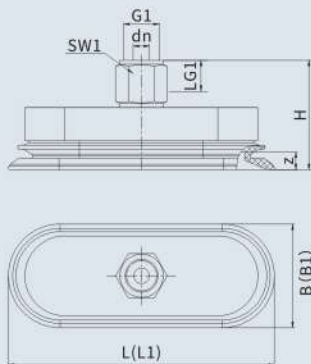

•MAOB60x30~110x55 (外螺纹)

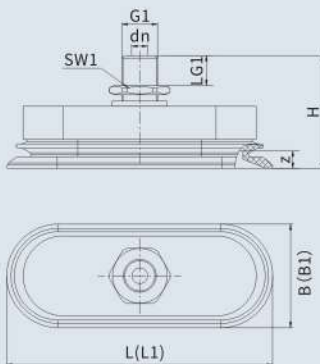

•MAOB60x30~110x55RA (矩形适配器)

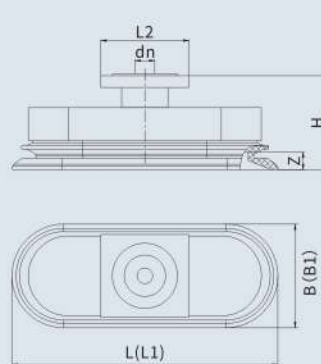

型号	尺寸mm	B	B1	dn	G1	H	L	L1	L2	LG1	SW1	Z
MAOB50x16G1/4-AG		32	33	5	G1/4M	27	62	63	-	8	17	7
MAOB50x16G1/4-IG		32	33	6	G1/4F	34.5	62	63	-	8	17	7
MAOB50x16G3/8-IG		32	33	6	G3/8F	35	62	63	-	9	22	7
MAOB50x16M10x1.5-AG		32	33	4	M10x1.5M	27	62	63	-	10	17	7
MAOB50x16M14x1.5-AG		32	33	5	M14x1.5M	29	62	63	-	10	22	7
MAOB50x16RA		32	33	4	-	30	62	63	32	-	-	7
MAOB60x23G1/4-AG		42	43	5	G1/4M	29.7	82	83	-	8	17	9
MAOB60x23G1/4-IG		42	43	6	G1/4F	37.2	82	83	-	8	17	9
MAOB60x23G3/8-IG		42	43	6	G3/8F	37.7	82	83	-	9	22	9
MAOB60x23M10x1.5-AG		42	43	4	M10x1.5M	29.7	82	83	-	10	17	9
MAOB60x23M14x1.5-AG		42	43	5	M14x1.5M	31.7	82	83	-	10	22	9
MAOB60x23RA		42	43	4	-	32.7	82	83	32	-	-	9
MAOB90x30G1/4-AG		57	59	6	G1/4M	35.5	112	114	-	8	17	13
MAOB90x30G1/4-IG		57	59	8	G1/4F	43	112	114	-	8	17	13
MAOB90x30G3/8-IG		57	59	8	G3/8F	43.5	112	114	-	9	22	13
MAOB90x30M10x1.5-AG		57	59	4	M10x1.5M	35.5	112	114	-	10	17	13
MAOB90x30M14x1.5-AG		57	59	6	M14x1.5M	37.5	112	114	-	10	22	13
MAOB90x30RA		57	59	6	-	38.5	112	114	32	-	-	13

- 吸盘及组件
- HXD
  - HOP
  - HNP
  - HNT
  - SCG
  - HXN
  - HGP
  - ZP
  - ZP3
  - ZP3E
  - ZP3P
  - ZP3P-JT3
  - ZP3P-JT5
  - MAF
  - MAB
  - MAOF
  - MAOB**
  - BK
  - PAG
  - PATK/PAYK
  - PATS
  - PAYS
  - PATKM/PAYKM
  - PCG
  - PCTK/PCYK
  - PFG
  - PFTK/PFYK
  - PFTS
  - PFYS
  - PFTKM/PFYKM
  - PJG
  - PJTK/PJYK
  - PJTS
  - PJYS
  - PJG
  - PS
  - PUG
  - PUTK/PUYK
  - PUTSB/PUYSB



### 产品特点

- \* 能保证在极限情况下吸附口袋, 克服普通吸盘开袋成功率低的缺陷。
- \* 唇边薄, 吸附软型工件密封性强
- \* 特殊的肋槽设计, 适用于吸附粗糙表面。
- \* 适用于塑料袋的开袋、装袋、纸张、塑料薄膜等软性工件

### 型号规格

**BK 26 - 01M**

①

②

③

①产品系列

②吸盘直径

③连接方式

BK - 开袋吸盘

26 - 26mm  
33 - 33mm

01M - G1/8外螺纹

### 规格尺寸(mm)

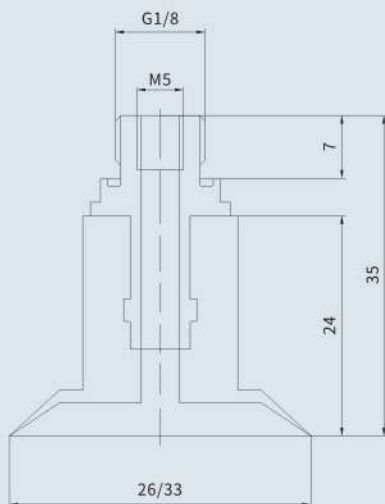



# PATK/PAYK系列

薄型吸盘附固定式金属底座



## 型号规格

**PA T K - 10A - N**

①

②

③

### ①真空口方向

T - 垂直方向  
 Y - 水平方向

### ②吸盘直径

10A 20A 30B  
 10B 20B 40A  
 15A 25A 50A  
 15B 30A

### ③吸盘材质

N - 丁腈橡胶  
 S - 硅橡胶  
 NE - 导电性丁腈橡胶  
 SE - 导电性硅橡胶

## 规格尺寸(mm)

垂直方向连接  
 •PATK

适合吸盘直径  
 Ø10·Ø15·Ø20

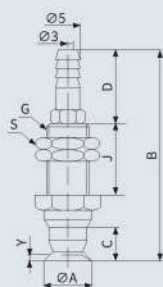

适合吸盘直径  
 Ø25·Ø30

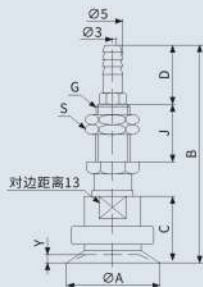

适合吸盘直径  
 Ø40·Ø50



S:六角对边尺寸

型号	A	B	C	D	Y	S	G	J
PATK-10	10	46	7.5	16	0.6	12H	M9×1	15.5
PATK-15	15	46	7.5	16	0.9	12H	M9×1	15.5
PATK-20	20	48.5	10	16	1.2	12H	M9×1	15.5
PATK-25	25	67.2	18	16	1.5	14H	M10	20
PATK-30	30	67.2	18	16	1.8	14H	M10	20
PATK-40	40	67.2	18	16	2.4	14H	M10	20
PATK-50	50	67.2	18	16	3	14H	M10	20

水平方向连接  
 •PAYK

适合吸盘直径  
 Ø10·Ø15·Ø20

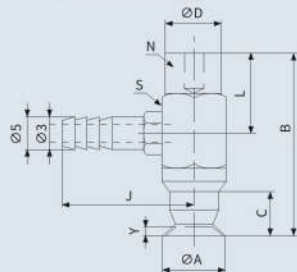

适合吸盘直径  
 Ø25·Ø30

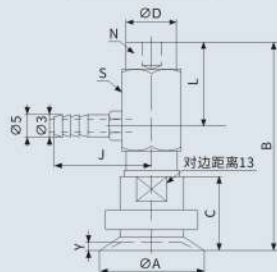

适合吸盘直径  
 Ø40·Ø50

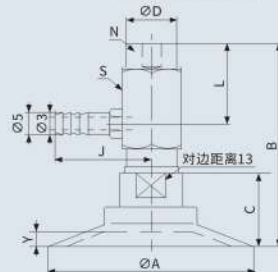

S:六角对边尺寸

型号	A	B	C	D	Y	S	G	J
PAYK-10	10	30	7.5	10	0.6	12	M4深6	16
PAYK-15	15	30	7.5	10	0.9	12	M4深6	16
PAYK-20	20	32.5	10	10	1.2	12	M4深6	16
PAYK-25	25	51.5	18	12	1.5	14	M6深8	18
PAYK-30	30	51.5	18	12	1.8	14	M6深8	18
PAYK-40	40	51.5	18	12	2.4	14	M6深8	18
PAYK-50	50	51.5	18	12	3	14	M6深8	18





**型号规格**

**PATS - 10A - 4 - N**

①                      ②                      ③

①吸盘直径			②行程		③吸盘材质
10A	20A	30B	4	20	N - 丁腈橡胶
10B	20B	40A	6	30	S - 硅橡胶
15A	25A	50A	10	50	NE - 导电性丁腈橡胶
15B	30A		15		SE - 导电性硅橡胶

**规格尺寸(mm)**

垂直方向连接  
•PATS

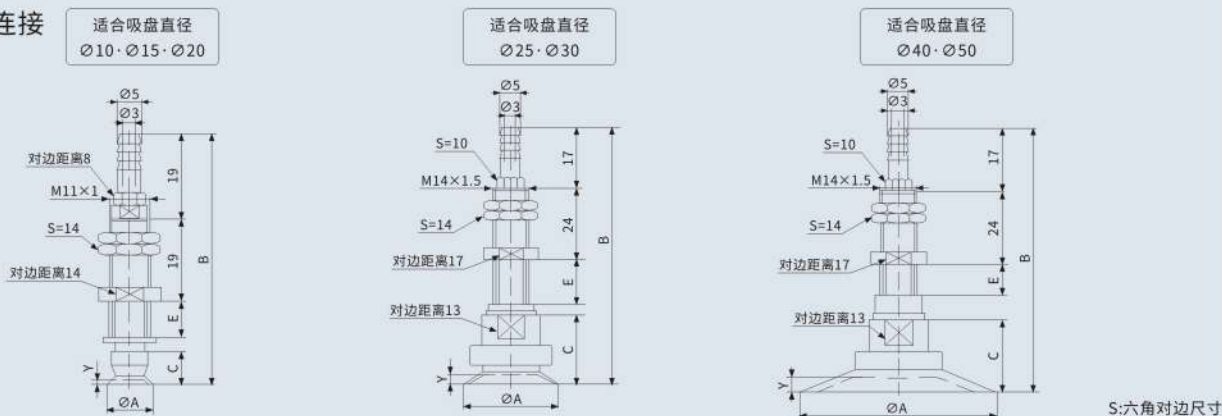

型号	A	B	C	E	Y
PATS - 10 - 4	10	56.5	7.5	8	0.6
PATS - 10 - 10	10	68.5	7.5	20	0.6
PATS - 10 - 20	10	88.5	7.5	40	0.6
PATS - 10 - 30	10	108.5	7.5	60	0.6
PATS - 15 - 4	15	56.5	7.5	8	0.9
PATS - 15 - 10	15	68.8	7.5	20	0.9
PATS - 15 - 20	15	88.5	7.5	40	0.9
PATS - 15 - 30	15	108.5	7.5	60	0.9
PATS - 20 - 4	20	59	10	8	1.2
PATS - 20 - 10	20	71	10	20	1.2
PATS - 20 - 20	20	91	10	40	1.2
PATS - 20 - 30	20	111	10	60	1.2
PATS - 25 - 6	25	76	18	13	1.5
PATS - 25 - 15	25	93	18	30	1.5
PATS - 25 - 30	25	123	18	60	1.5
PATS - 25 - 50	25	163	18	100	1.5
PATS - 30 - 6	30	76	18	13	1.8
PATS - 30 - 15	30	93	18	30	1.8
PATS - 30 - 30	30	126	18	60	1.8
PATS - 30 - 50	30	163	18	100	1.8
PATS - 40 - 6	40	76	18	13	2.4
PATS - 40 - 15	40	93	18	30	2.4
PATS - 40 - 30	40	123	18	60	2.4
PATS - 40 - 50	40	163	18	100	2.4
PATS - 50 - 6	50	76	18	13	3
PATS - 50 - 15	50	93	18	30	3
PATS - 50 - 30	50	123	18	60	3
PATS - 50 - 50	50	163	18	100	3

吸盘及组件

- HXD
- HOP
- HNP
- HNT
- SCG
- HXN
- HGP
- ZP
- ZP3
- ZP3E
- ZP3P
- ZP3P-JT3
- ZP3P-JT5
- MAF
- MAB
- MAOF
- MAOB
- BK
- PAG
- PATK/PAYK
- PATS
- PAYS
- PATKM/PAYKM
- PCG
- PCTK/PCYK
- PFG
- PFTK/PFYK
- PFTS
- PFYS
- PFTKM/PFYKM
- PJG
- PJTK/PJYK
- PJTS
- PJYS
- PJG
- PS
- PUG
- PUTK/PUYK
- PUTSB/PUYSB



# PATKM/PAYKM系列

薄型吸盘附缓冲式金属底座及快速接管型



## 型号规格

PA T KM - 10A - N

①

②

③

①真空口方向

②吸盘直径

③吸盘材质

T - 垂直方向  
Y - 水平方向

10A 20A 30B  
10B 20B 40A  
15A 25A 50A  
15B 30A

N - 丁腈橡胶  
S - 硅橡胶  
NE - 导电性丁腈橡胶  
SE - 导电性硅橡胶

## 规格尺寸(mm)

垂直方向连接  
•PATKM

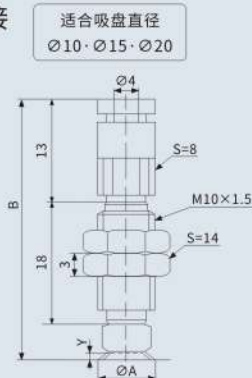

适合吸盘直径  
Ø10·Ø15·Ø20

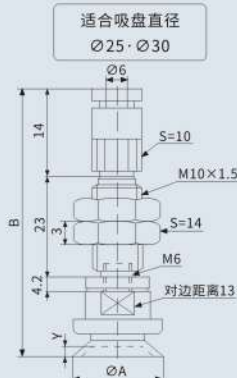

适合吸盘直径  
Ø25·Ø30

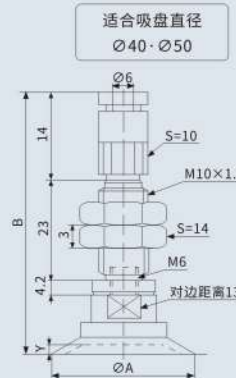

适合吸盘直径  
Ø40·Ø50

S:六角对边尺寸

型号	A	B	Y
PATKM - 10	10	38.5	0.6
PATKM - 15	15	38.5	0.9
PATKM - 20	20	41	1.2
PATKM - 25	25	59.2	1.5
PATKM - 30	30	59.2	1.8
PATKM - 40	40	59.2	2.4
PATKM - 50	50	59.2	3

水平方向连接  
•PAYKM

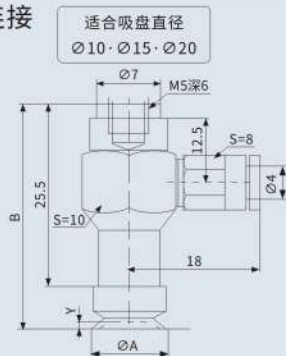

适合吸盘直径  
Ø10·Ø15·Ø20

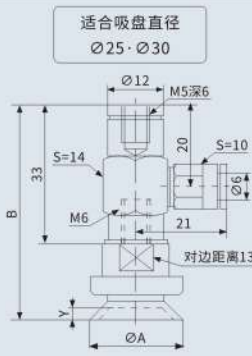

适合吸盘直径  
Ø25·Ø30



适合吸盘直径  
Ø40·Ø50

S:六角对边尺寸

型号	A	B	Y
PATKM - 10	10	33	0.6
PATKM - 15	15	33	0.9
PATKM - 20	20	35.5	1.2
PATKM - 25	25	51.2	1.5
PATKM - 30	30	51.2	1.8
PATKM - 40	40	51.2	2.4
PATKM - 50	50	51.2	3

吸盘及组件

HXD  
HOP  
HNP  
HNT  
SCG  
HXN  
HGP  
ZP  
ZP3  
ZP3E  
ZP3P  
ZP3P-JT3  
ZP3P-JT5  
MAF  
MAB  
MAOF  
MAOB  
BK  
PAG  
PATK/PAYK  
PATS  
PAYS  
PATKM/PAYKM  
PCG  
PCTK/PCYK  
PFG  
PFTK/PFYK  
PFTS  
PFYS  
PFTKM/PFYKM  
PJG  
PJTK/PJYK  
PJTS  
PJYS  
PJG  
PS  
PUG  
PUTK/PUYK  
PUTSB/PUYSB



**产品特点**

- \* 三段式设计, 吸附能力强。
- \* 吸盘有多层褶皱, 具有一定的缓冲量, 适用于表面不平整的物件和纸张, 塑料膜的吸附。

**型号规格**

**PCG - 10 - N**  
①                      ②

①吸盘直径		②吸盘材质	
5	20	N	- 丁腈橡胶
7	30	S	- 硅橡胶
10	40	NE	- 导电性丁腈橡胶
15	60	SE	- 导电性硅橡胶
18	90		

**规格尺寸(mm)**

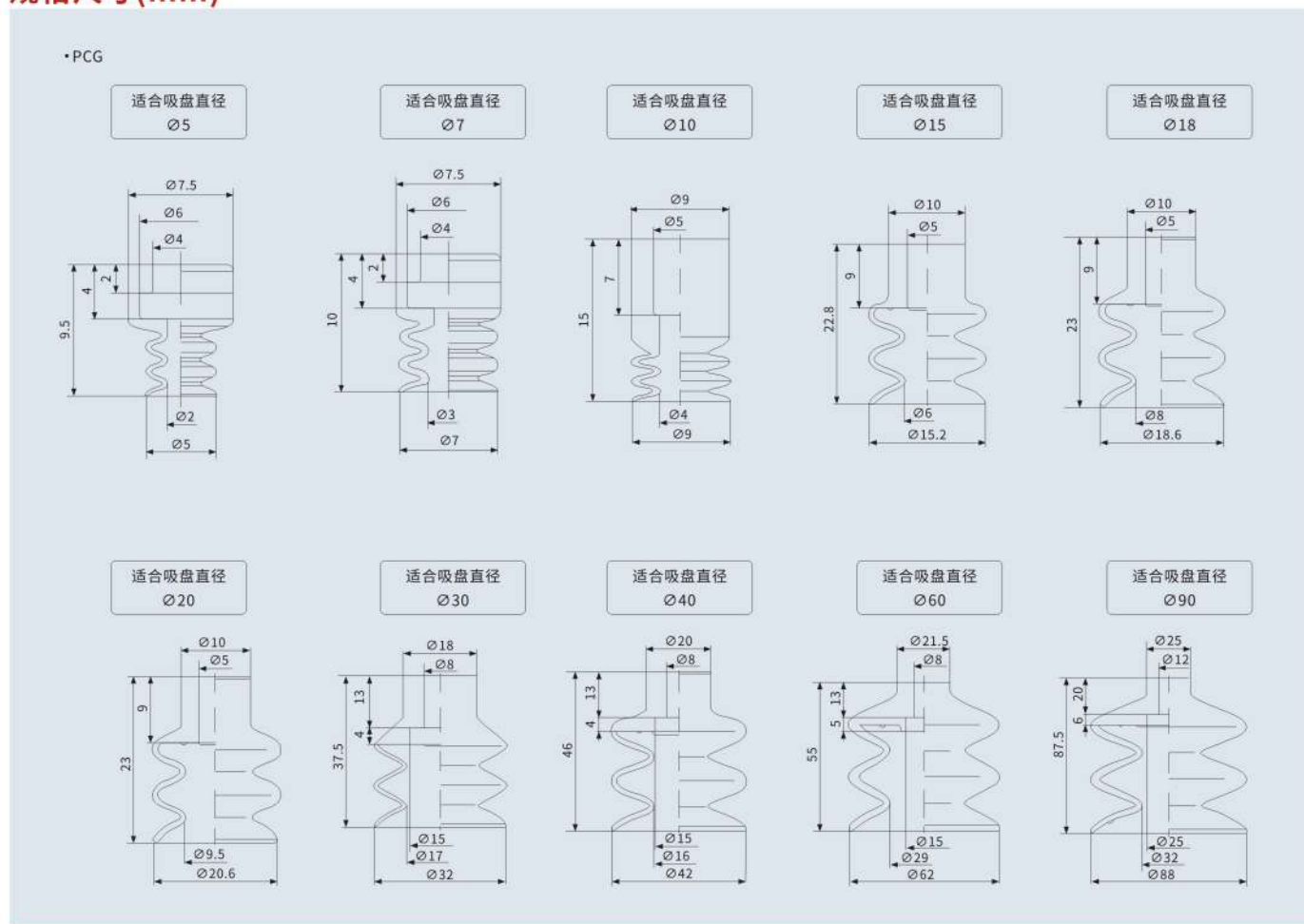



# PCTK/PCYK系列

三段式吸盘附接头固定式金属配件



## 型号规格

PC T K - 10 - N  
① ② ③

### ①产品系列

T - 垂直方向  
Y - 水平方向

### ②溢流口直径

10A 25A  
10B 30A  
15A 30B  
15B 40A  
20A 50A  
20B

### ③吸盘材质

N - 丁腈橡胶  
S - 硅橡胶  
NE - 导电性丁腈橡胶  
SE - 导电性硅橡胶

## 规格尺寸(mm)

垂直方向连接

•PCTK

适合吸盘直径  
Ø5·Ø7

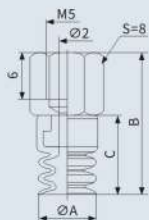

适合吸盘直径  
Ø5·Ø7

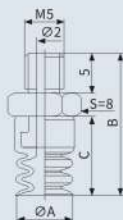

适合吸盘直径  
Ø10·Ø15·Ø18·Ø20

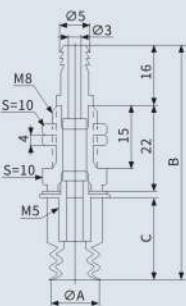

适合吸盘直径  
Ø30·Ø40·Ø60

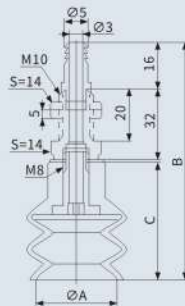

适合吸盘直径  
Ø90

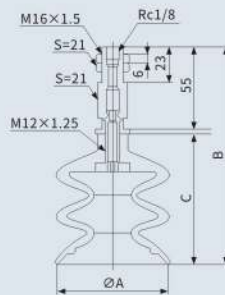

S:六角对边尺寸

型号	A	B	C
PCTK-5	5	17.5	9.5
PCTK-7	7	18	10
PCTK-10	9	56.2	15
PCTK-15	14	64.2	23
PCTK-18	18.6	64.2	23
PCTK-20	20.6	64.2	23
PCTK-30	32	86.8	37.5
PCTK-40	42	95.3	46
PCTK-60	62	104.3	56
PCTK-90	88	144.8	87.5

- 吸盘及组件
- HXD
  - HOP
  - HNP
  - HNT
  - SCG
  - HXN
  - HGP
  - ZP
  - ZP3
  - ZP3E
  - ZP3P
  - ZP3P-JT3
  - ZP3P-JT5
  - MAF
  - MAB
  - MAOF
  - MAOB
  - BK
  - PAG
  - PATK/PAYK
  - PATS
  - PAYS
  - PATKM/PAYKM
  - PCG
  - PCTK/PCYK
  - PFG
  - PFTK/PFYK
  - PFTS
  - PFYS
  - PFTKM/PFYKM
  - PJG
  - PJTK/PJYK
  - PJTS
  - PJYS
  - PJG
  - PS
  - PUG
  - PUTK/PUYK
  - PUTSB/PUYSB







**产品特点**

- \*标准平型吸盘。
- \*适用于钢板、板材等表面平整的吸附物。
- \*吸附能力强大稳定。

**型号规格**

**PFG - ① - ② - N**

①吸盘直径

2	20	80
3.5	25	95
5	30	120
6	35	150
8	40	200
10	50	
15	60	

②吸盘材质

- N - 丁腈橡胶
- S - 硅橡胶
- NE - 导电性丁腈橡胶
- SE - 导电性硅橡胶

**规格尺寸(mm)**

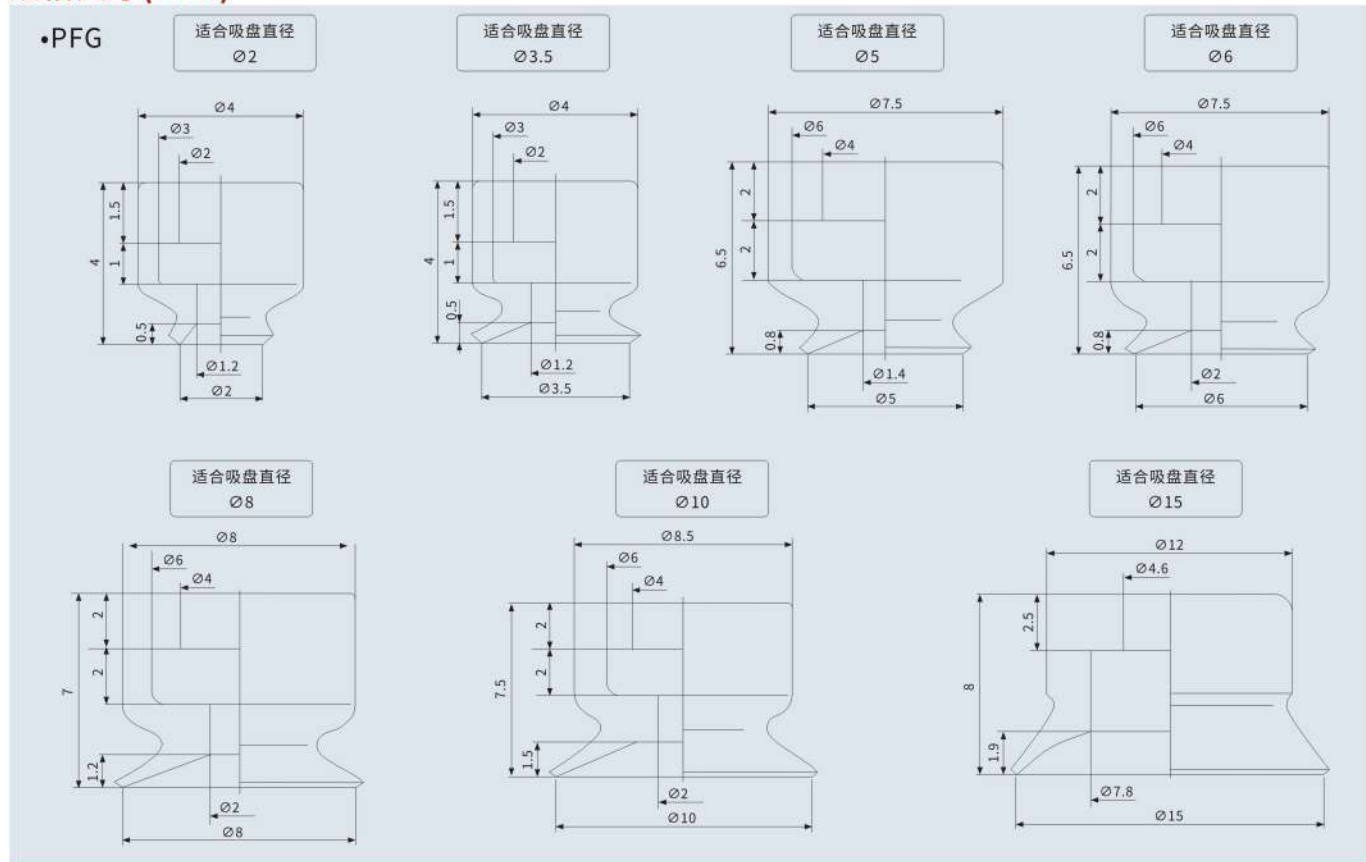

**吸盘及组件**

- HXD
- HOP
- HNP
- HNT
- SCG
- HXN
- HGP
- ZP
- ZP3
- ZP3E
- ZP3P
- ZP3P-JT3
- ZP3P-JT5
- MAF
- MAB
- MAOF
- MAOB
- BK
- PAG
- PATK/PAYK
- PATS
- PAYS
- PATKM/PAYKM
- PCG
- PCTK/PCYK
- PFG**
- PFTK/PFYK
- PFTS
- PFYS
- PFTKM/PFYKM
- PJG
- PJTK/PJYK
- PJTS
- PJYS
- PJG
- PS
- PUG
- PUTK/PUYK
- PUTSB/PUYSB

规格尺寸(mm)

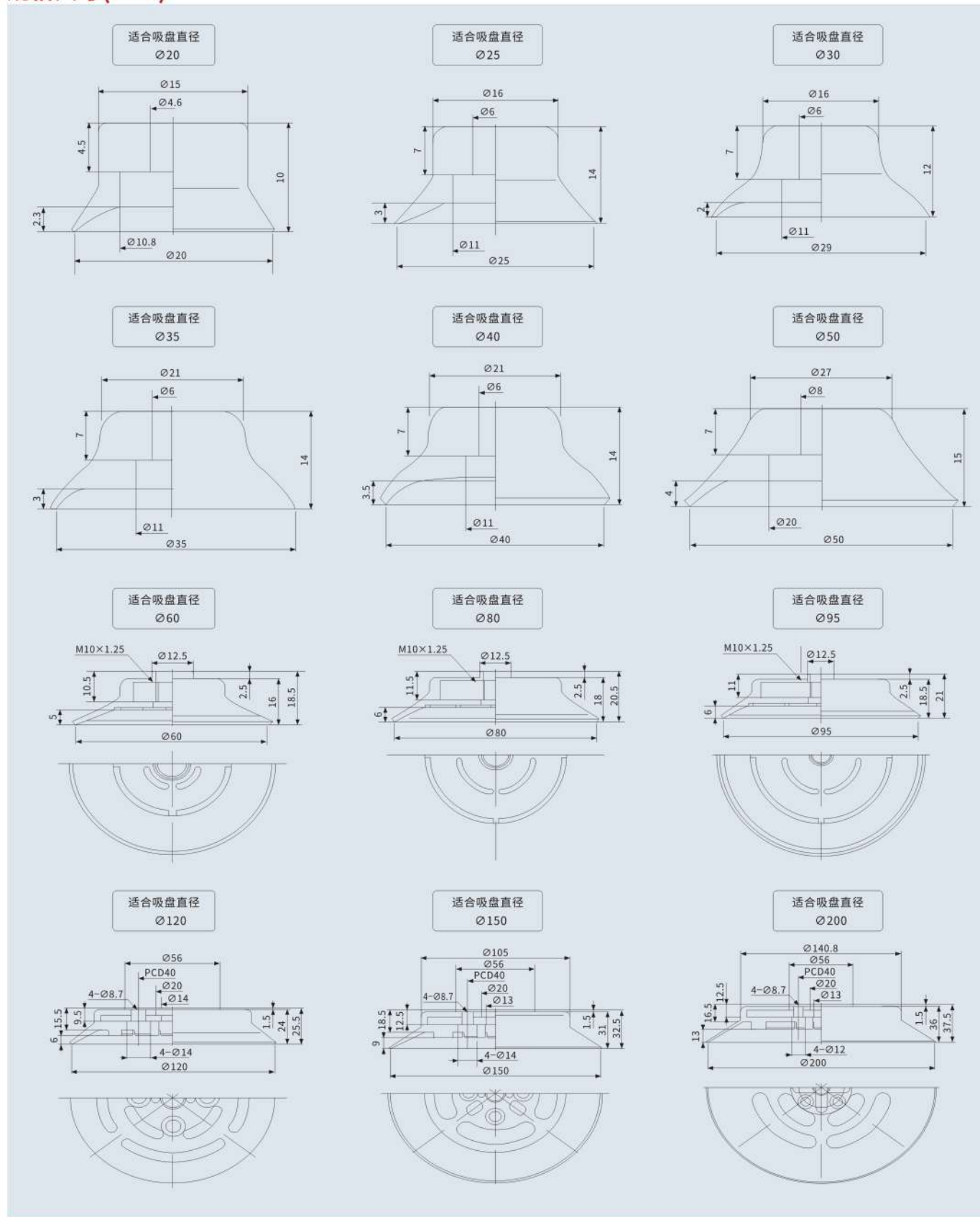

# PFTK/PFYK系列

标准型吸盘固定金属底座



## 型号规格

**PF T K - 2 - N**

①

②

③

### ①真空口方向

T - 垂直方向  
Y - 水平方向

### ②吸盘直径

2	20	80
3.5	25	95
5	30	100
6	35	120
8	40	150
10	50	200
15	60	

### ③吸盘材质

N - 丁腈橡胶  
S - 硅橡胶  
NE - 导电性丁腈橡胶  
SE - 导电性硅橡胶

## 规格尺寸(mm)

### 垂直方向连接 •PFTK

适合吸盘直径  
Ø2·Ø3.5

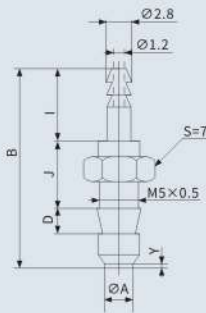

适合吸盘直径  
Ø5·Ø6·Ø8·Ø10

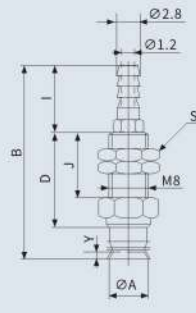

适合吸盘直径  
Ø15·Ø20·Ø25·Ø30·Ø35·Ø40·Ø50

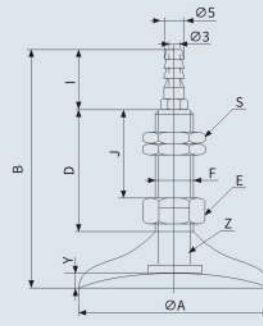

适合吸盘直径  
Ø60·Ø80·Ø95

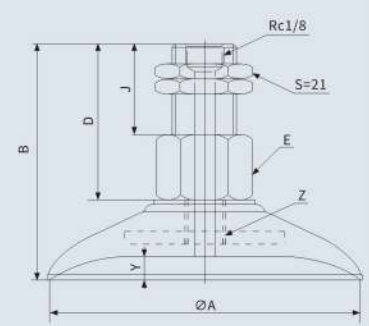

S:六角对边尺寸

型号	A	B	D	E	F	I	J	S	Y	Z
PFTK-2	2	23.5	3	-	-	8.5	8	-	0.5	-
PFTK-3.5	3.5	23.5	3	-	-	8.5	8	-	0.5	-
PFTK-5	5	30.5	14	-	-	10	12	12H	0.8	-
PFTK-6	6	30.5	14	-	-	10	12	12H	0.8	-
PFTK-8	8	31	14	-	-	10	12	12H	1.2	-
PFTK-10	10	46	22.5	10H	M8×1.25	16	15.5	12H	1.5	-
PFTK-15	15	46	22	10H	M8×1.25	16	15	10H	1.9	M5
PFTK-20	20	48	22	10H	M10×1.5	16	15	10H	2.3	M5
PFTK-25	25	62	32	14H	M10×1.5	16	20	14H	3.0	M6
PFTK-30	30	60	32	14H	M10×1.5	16	20	14H	2.0	M6
PFTK-35	35	62	32	14H	M10×1.5	16	20	14H	3.0	M6
PFTK-40	40	62	32	14H	M10×1.5	16	20	14H	3.5	M6
PFTK-50	50	63	32	14H	M10×1.5	16	20	14H	4.0	M8
PFTK-60	60	58.5	40	21H	-	-	23	-	5.0	M10×1.25
PFTK-80	80	60.5	40	21H	-	-	23	-	6.0	M10×1.25
PFTK-95	95	61	40	21H	-	-	23	-	6.0	M10×1.25

- HXD
- HOP
- HNP
- HNT
- SCG
- HXN
- HGP
- ZP
- ZP3
- ZP3E
- ZP3P
- ZP3P-JT3
- ZP3P-JT5
- MAF
- MAB
- MAOF
- MAOB
- BK
- PAG
- PATK/PAYK
- PATS
- PAYS
- PATKM/PAYKM
- PCG
- PCTK/PCYK
- PFG
- PFTK/PFYK**
- PFTS
- PFYS
- PFTKM/PFYKM
- PJG
- PJTK/PJYK
- PJTS
- PJYS
- PJG
- PS
- PUG
- PUTK/PUYK
- PUTSB/PUYSB

**规格尺寸(mm)**

水平方向连接  
•PFYK

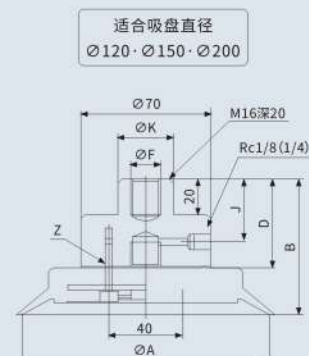
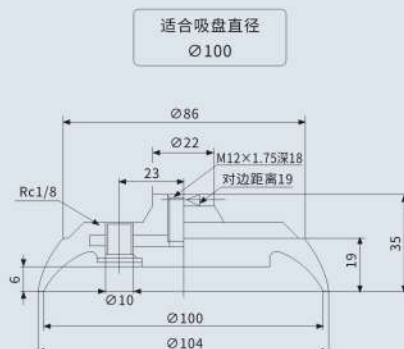
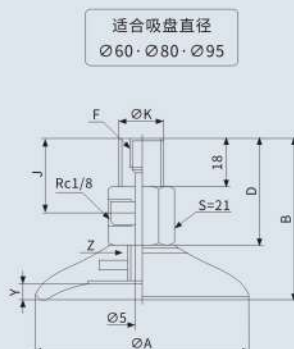
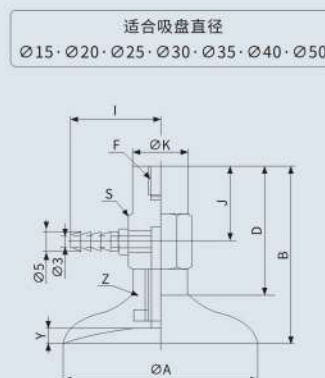
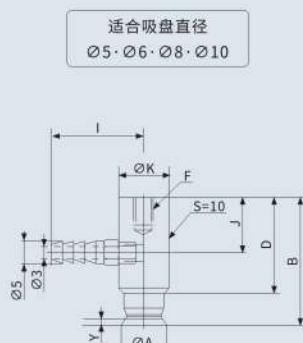
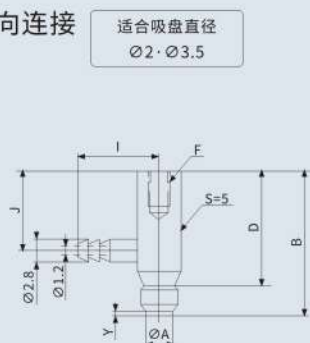

S:六角对边尺寸

型号	A	B	D	E	F	I	J	S	Y	Z
PFYK-2	2	20	16	-	M3深5	11	11	-	0.5	-
PFYK-3.5	3.5	20	16	-	M3深5	11	11	-	0.5	-
PFYK-5	5	29	22.5	-	M4深6	21	13	10	0.8	-
PFYK-6	6	29	22.5	-	M4深6	21	13	10	0.8	-
PFYK-8	8	29.5	22.5	-	M4深6	21	13	10	1.2	-
PFYK-10	10	30	22.5	-	M4深6	21	13	10	1.5	-
PFYK-15	15	30	22	-	M4深6	21	14	10	1.9	M5
PFYK-20	20	32	22	-	M4深6	21	14	10	2.3	M5
PFYK-25	25	46	32	14H	M6深8	23	20	12	3.0	M6
PFTK-30	30	44	32	14H	M6深8	23	20	12	2.0	M6
PFYK-35	35	46	32	14H	M6深8	23	20	12	3.0	M6
PFYK-40	40	46	32	14H	M6深8	23	20	12	3.5	M6
PFYK-50	50	47	32	14H	M6深8	23	20	12	4.0	M8
PFYK-60	60	58.5	40	-	M8深11	-	28	17	5.0	M10×1.25
PFYK-80	80	60.5	40	-	M8深11	-	28	17	6.0	M10×1.25
PFYK-95	95	61	40	-	M8深11	-	28	17	6.0	M10×1.25
PFYK-100	-	-	-	-	-	-	-	-	-	-
PFYK-120	120	75.5	50	-	M16深20	-	38	30	6.0	4-M8
PFYK-150	150	82.5	50	-	M16深20	-	38	30	9.0	4-M8
PFYK-200	200	87.5	50	-	M16深20	-	38	30	13.0	4-M8



# PFTS系列

标准立向缓冲吸盘组



## 型号规格

PFTS - 10 - 4 - N

①

②

③

### ①吸盘直径

2	15	50
3.5	20	60
5	25	80
6	30	95
8	35	
10	45	

### ②行程

2.5	15
3	20
4	25
5	30
6	50
10	70

### ③吸盘材质

N - 丁腈橡胶  
S - 硅橡胶  
NE - 导电性丁腈橡胶  
SE - 导电性硅橡胶

## 规格尺寸(mm)

### •PFTS

适合吸盘直径  
Ø2·Ø3.5

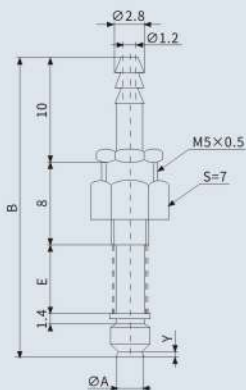

适合吸盘直径  
Ø5·Ø6·Ø8·Ø10

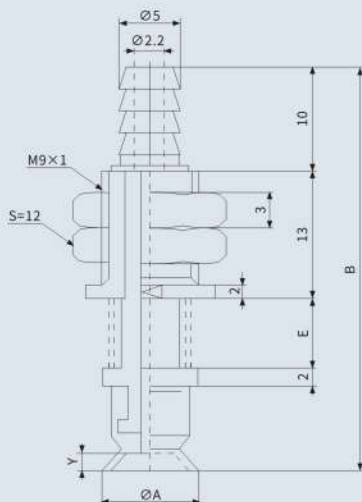

适合吸盘直径  
Ø10

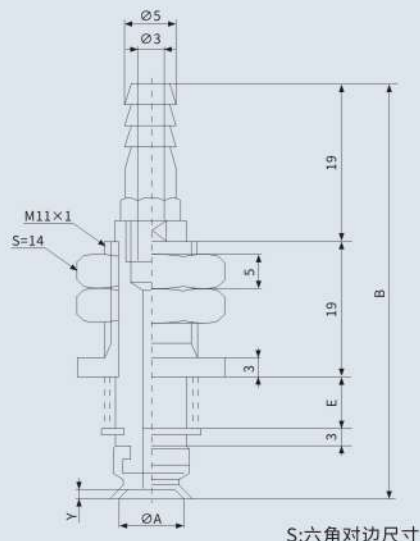

S:六角对边尺寸

型号	A	B	E	Y
PFTS-2-2.5	2	28.5	5.1	0.5
PFTS-2-5	2	33.5	10.1	0.5
PFTS-3.5-2.5	3.5	28.5	5.1	0.5
PFTS-3.5-5	3.5	33.5	10.1	0.5
PFTS-5-3	5	37.5	6	0.8
PFTS-5-10	5	51.5	20	0.8
PFTS-5-15	5	61.5	30	0.8
PFTS-5-25	5	61.5	50	0.8
PFTS-6-3	6	37.5	6	0.8
PFTS-6-10	6	51.5	20	0.8
PFTS-6-15	6	61.5	30	0.8
PFTS-6-25	6	81.5	50	0.8
PFTS-8-3	8	38	6	1.2

吸盘及组件

HXD  
HOP  
HNP  
HNT  
SCG  
HXN  
HGP  
ZP  
ZP3  
ZP3E  
ZP3P  
ZP3P-JT3  
ZP3P-JT5  
MAF  
MAB  
MAOF  
MAOB  
BK  
PAG  
PATK/PAYK  
PATS  
PAYS  
PATKM/PAYKM  
PCG  
PCTK/PCYK  
PFG  
PFTK/PFYK  
PFTS  
PFYS  
PFTKM/PFYKM  
PJG  
PJTK/PJYK  
PJTS  
PJYS  
PJG  
PS  
PUG  
PUTK/PUYK  
PUTSB/PUYSB

型号	A	B	E	Y
PFTS-8-10	8	52	20	1.2
PFTS-8-15	8	62	30	1.2
PFTS-8-25	8	82	50	1.2
PFTS-10-4	10	56.5	8	1.5
PFTS-10-10	10	68.5	20	1.5
PFTS-10-20	10	88.5	40	1.5
PFTS-10-30	10	108.5	60	1.5

**规格尺寸(mm)**

•PFTS

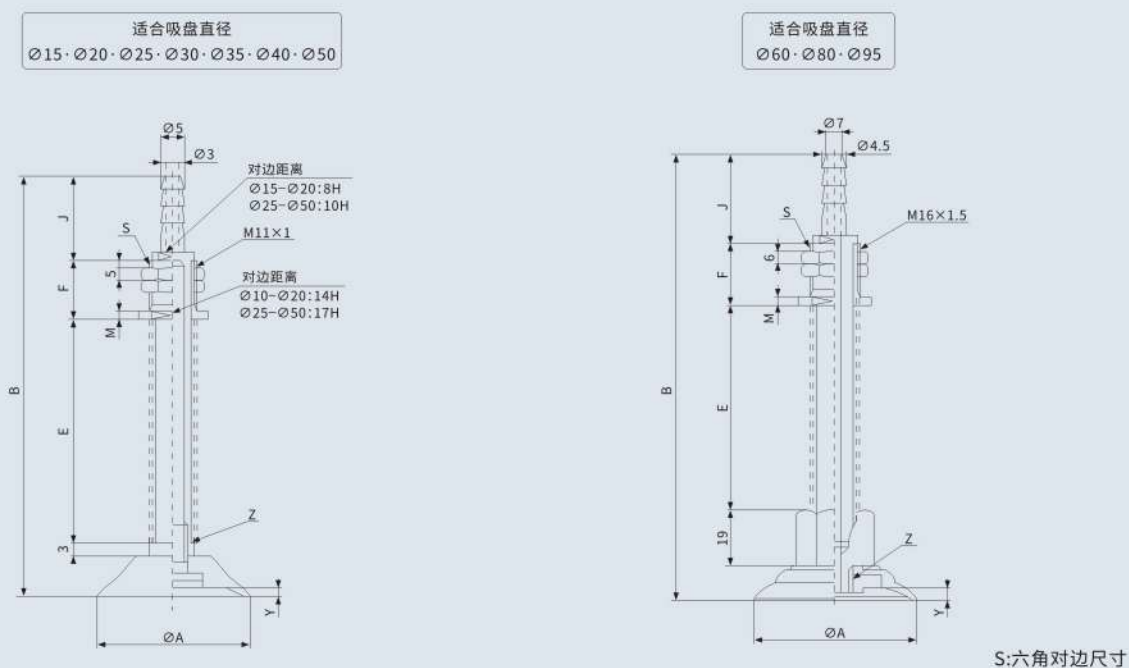

型号	A	B	E	F	J	S	Y	Z
PFTS-15-4	15	54	8	19	16	14H	1.9	M5
PFTS-15-10	15	66	20	19	16	14H	1.9	M5
PFTS-15-20	15	86	40	19	16	14H	1.9	M5
PFTS-15-30	15	106	60	19	16	14H	1.9	M5
PFTS-20-4	20	56	8	19	16	14H	2.3	M5
PFTS-20-10	20	68	20	19	16	14H	2.3	M5
PFTS-20-20	20	88	40	19	16	14H	2.3	M5
PFTS-20-30	20	108	60	19	16	14H	2.3	M5
PFTS-25-6	25	71	13	24	17	17H	3.0	M6
PFTS-25-15	25	88	30	24	17	17H	3.0	M6
PFTS-25-30	25	118	60	24	17	17H	3.0	M6
PFTS-25-50	25	158	100	24	17	17H	3.0	M6
PFTS-30-6	30	69	13	24	17	17H	2.0	M6
PFTS-30-15	30	86	30	24	17	17H	2.0	M6
PFTS-30-30	30	116	60	24	17	17H	2.0	M6
PFTS-30-50	30	156	100	24	17	17H	2.0	M6
PFTS-35-6	35	71	13	24	17	17H	3.0	M6
PFTS-35-15	35	88	30	24	17	17H	3.0	M6
PFTS-35-30	35	118	60	24	17	17H	3.0	M6
PFTS-35-50	35	158	100	24	17	17H	3.0	M6

型号	A	B	E	F	J	S	Y	Z
PFTS-40-6	40	71	13	24	17	17H	3.5	M6
PFTS-40-15	40	88	30	24	17	17H	3.5	M6
PFTS-40-30	40	118	60	24	17	17H	3.5	M6
PFTS-40-50	40	158	100	24	17	17H	3.5	M6
PFTS-50-6	50	72	13	24	17	17H	4.0	M6
PFTS-50-15	50	89	30	24	17	17H	4.0	M6
PFTS-50-30	50	119	60	24	17	17H	4.0	M6
PFTS-50-50	50	159	100	24	17	17H	4.0	M6
PFTS-60-10	60	110.5	20	24	17	17H	5.0	M10
PFTS-60-30	60	150.5	60	24	17	17H	5.0	M10
PFTS-60-50	60	190.5	100	24	17	17H	5.0	M10
PFTS-60-70	60	230.5	140	24	17	17H	5.0	M10
PFTS-80-10	80	112.5	20	24	17	17H	6.0	M10
PFTS-80-30	80	152.6	60	24	17	17H	6.0	M10
PFTS-80-50	80	192.5	100	24	17	17H	6.0	M10
PFTS-80-70	80	232.5	140	24	17	17H	6.0	M10
PFTS-95-10	93	113	20	24	17	17H	6.0	M10
PFTS-95-30	93	153	60	24	17	17H	6.0	M10
PFTS-95-50	93	193	100	24	17	17H	6.0	M10
PFTS-95-70	93	233	140	24	17	17H	6.0	M10

## 吸盘及组件

- HXD
- HOP
- HNP
- HNT
- SCG
- HXN
- HGP
- ZP
- ZP3
- ZP3E
- ZP3P
- ZP3P-JT3
- ZP3P-JT5
- MAF
- MAB
- MAOF
- MAOB
- BK
- PAG
- PATK/PAYK
- PATS
- PAYS
- PATKM/PAYKM
- PCG
- PCTK/PCYK
- PFG
- PFTK/PFYK
- PFTS**
- PFYS
- PFTKM/PFYKM
- PJG
- PJTK/PJYK
- PJTS
- PJYS
- PJG
- PS
- PUG
- PUTK/PUYK
- PUTSB/PUYSB



**型号规格**

**PFYS - 10 - 4 - N**

①                      ②                      ③

①吸盘直径		②行程		③吸盘材质
2	35	2.5	15	<b>N</b> - 丁腈橡胶 <b>S</b> - 硅橡胶 <b>NE</b> - 导电性丁腈橡胶 <b>SE</b> - 导电性硅橡胶
3.5	40	3	20	
5	50	4	25	
6	60	5	30	
8	80	6	50	
10	95	10	70	
15	100			
20	120			
25	150			
30	200			

**规格尺寸(mm)**

•PFYS

适合吸盘直径  
Ø2·Ø3.5

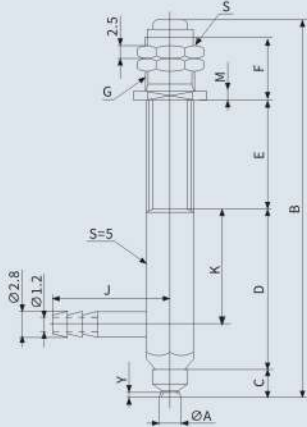

适合吸盘直径  
Ø5·Ø6·Ø8·Ø10

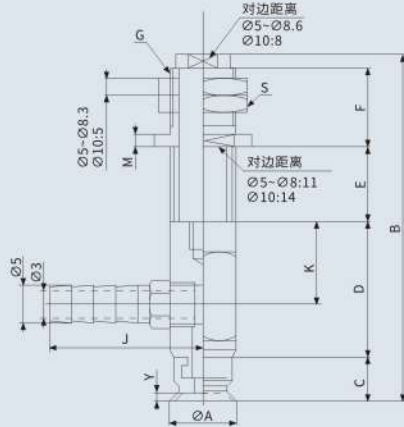

适合吸盘直径  
Ø15·Ø20·Ø25·Ø30·Ø35·Ø40·Ø50

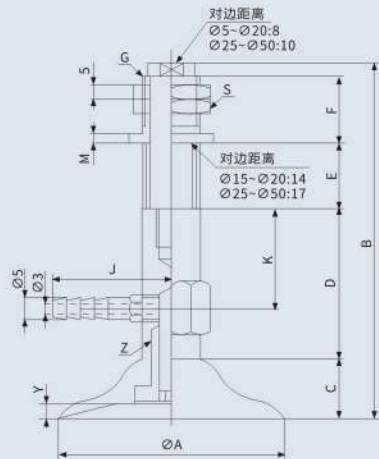

S:六角对边尺寸

型号	A	B	C	D	E	F	G	J	K	S	M	Y	Z
PFYS-2-2.5	2	35.7	4	16.4	4.5	9	M5	11	11	7H	1.5	0.5	-
PFYS-2-5	2	40.7	4	16.4	9.5	9	M5	11	11	7H	1.5	0.5	-
PFYS-3.5-2.5	3.5	35.7	4	16.4	4.5	9	M5	11	11	7H	1.5	0.5	-
PFYS-3.5-5	3.5	40.7	4	16.4	9.5	9	M5	11	11	7H	1.5	0.5	-
PFYS-5-3	5	51	6.5	22.5	6	13	M9×P1	21	13	12H	2	0.8	-
PFYS-5-10	5	65	6.5	22.5	20	13	M9×P1	21	13	12H	2	0.8	-
PFYS-5-15	5	75	6.5	22.5	30	13	M9×P1	21	13	12H	2	0.8	-
PFYS-5-25	5	95	6.5	22.5	50	13	M9×P1	21	13	12H	2	0.8	-
PFYS-6-3	6	51	6.5	22.5	6	13	M9×P1	21	13	12H	2	0.8	-
PFYS-6-10	6	65	6.5	22.5	20	13	M9×P1	21	13	12H	2	0.8	-
PFYS-6-15	6	75	6.5	22.5	30	13	M9×P1	21	13	12H	2	0.8	-
PFYS-6-25	6	95	6.5	22.5	50	13	M9×P1	21	13	12H	2	0.8	-
PFYS-8-3	8	51.5	7	22.5	6	13	M9×P1	21	13	12H	2	1.2	-
PFYS-8-10	8	65.5	7	22.5	20	13	M9×P1	21	13	12H	2	1.2	-
PFYS-8-15	8	75.5	7	22.5	30	13	M9×P1	21	13	12H	2	1.2	-
PFYS-8-25	8	95.5	7	22.5	50	13	M9×P1	21	13	12H	2	1.2	-
PFYS-10-4	10	60	7.5	22.5	8	19	M11×P1	21	13	14H	3	1.5	-
PFYS-10-10	10	72	7.5	22.5	20	19	M11×P1	21	13	14H	3	1.5	-
PFYS-10-20	10	92	7.5	22.5	40	19	M11×P1	21	13	14H	3	1.5	-
PFYS-10-30	10	112	7.5	22.5	60	19	M11×P1	21	13	14H	3	1.5	-

吸盘及组件

HXD  
HOP  
HNP  
HNT  
SCG  
HXN  
HGP  
ZP  
ZP3  
ZP3E  
ZP3P  
ZP3P-JT3  
ZP3P-JT5  
MAF  
MAB  
MAOF  
MAOB  
BK  
PAG  
PATK/PAYK  
PATS  
PAYS  
PATKM/PAYKM  
PCG  
PCTK/PCYK  
PFG  
PFTK/PFYK  
PFTS  
**PFYS**  
PFTKM/PFYKM  
PJG  
PJTK/PJYK  
PJTS  
PJYS  
PJG  
PS  
PUG  
PUTK/PUYK  
PUTSB/PUYSB

## 规格尺寸(mm)

### •PFYS

适合吸盘直径  
Ø60·Ø80·Ø95

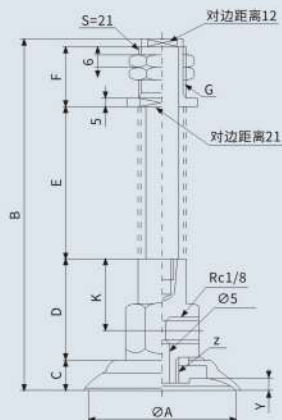

适合吸盘直径  
Ø100

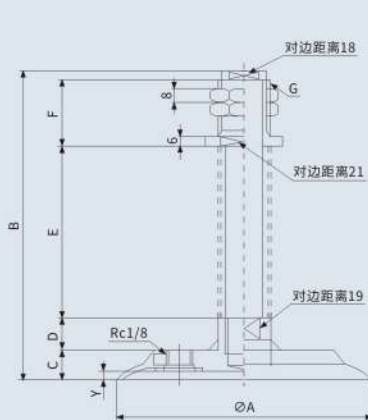

适合吸盘直径  
Ø120·Ø150·Ø200

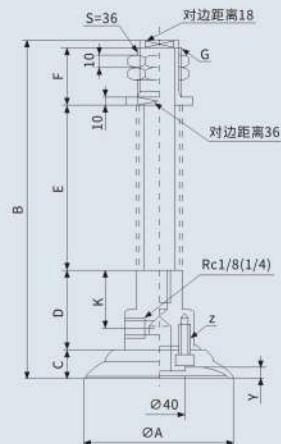

S:六角对边尺寸



型号	A	B	C	D	E	F	G	J	K	S	M	Y	Z
PFYS-15-4	15	60	8	22	8	19	M11×P1	31	14	14H	3	1.9	M5
PFYS-15-10	15	72	8	22	20	19	M11×P1	31	14	14H	3	1.9	M5
PFYS-15-20	15	92	8	22	40	19	M11×P1	31	14	14H	3	1.9	M5
PFYS-15-30	15	112	8	22	60	19	M11×P1	31	14	14H	3	1.9	M5
PFYS-20-4	20	62	10	22	8	19	M11×P1	31	14	14H	3	2.3	M5
PFYS-20-10	20	74	10	22	20	19	M11×P1	31	14	14H	3	2.3	M5
PFYS-20-20	20	94	10	22	40	19	M11×P1	31	14	14H	3	2.3	M5
PFYS-20-30	20	114	10	22	60	19	M11×P1	31	14	14H	3	2.3	M5
PFYS-25-6	25	81	14	32	13	24	M14×P1.5	23	20	17H	4	3.0	M6
PFYS-25-15	25	104	14	32	30	24	M14×P1.5	23	20	17H	4	3.0	M6
PFYS-25-30	25	134	14	32	60	24	M14×P1.5	23	20	17H	4	3.0	M6
PFYS-25-50	25	174	14	32	100	24	M14×P1.5	23	20	17H	4	3.0	M6
PFYS-30-6	30	85	12	32	13	24	M14×P1.5	23	20	17H	4	2.0	M6
PFYS-30-15	30	102	12	32	30	24	M14×P1.5	23	20	17H	4	2.0	M6
PFYS-30-30	30	132	12	32	60	19	M14×P1.5	23	20	17H	4	2.0	M6
PFYS-30-50	30	172	12	32	100	24	M14×P1.5	23	20	17H	4	2.0	M6
PFYS-35-6	35	87	14	32	13	24	M14×P1.5	23	20	17H	4	3.0	M6
PFYS-35-15	35	104	14	32	30	24	M14×P1.5	23	20	17H	4	3.0	M6
PFYS-35-30	35	134	14	32	60	24	M14×P1.5	23	20	17H	4	3.0	M6
PFYS-35-50	35	174	14	32	100	24	M14×P1.5	23	20	17H	4	3.0	M6
PFYS-40-6	40	87	14	32	13	24	M14×P1.5	23	20	17H	4	3.5	M8
PFYS-40-15	40	104	14	40	30	24	M14×P1.5	23	20	17H	4	3.5	M8
PFYS-40-30	40	134	14	32	60	24	M14×P1.5	23	20	17H	4	3.5	M8
PFYS-40-50	40	174	14	32	100	24	M14×P1.5	23	20	17H	4	3.5	M8
PFYS-50-6	50	88	14	32	13	24	M14×P1.5	23	20	17H	4	4.0	M8
PFYS-50-15	50	105	14	32	30	24	M14×P1.5	23	20	17H	4	4.0	M8
PFYS-50-30	50	135	14	32	60	24	M14×P1.5	23	20	17H	4	4.0	M8
PFYS-50-50	50	175	15	32	100	24	M14×P1.5	23	20	17H	4	4.0	M8
PFYS-60-10	60	110.5	18.5	40	20	28	M16×P1.5	-	28	21H	5	5.0	M10×P1.25
PFYS-60-30	60	150.5	18.5	40	60	28	M16×P1.5	-	28	21H	5	5.0	M10×P1.25
PFYS-60-50	60	190.5	18.5	40	100	28	M16×P1.5	-	28	21H	5	5.0	M10×P1.25
PFYS-60-70	60	230.5	18.5	40	140	28	M16×P1.5	-	28	21H	5	5.0	M10×P1.25
PFYS-80-10	80	112.5	20.5	40	20	28	M16×P1.5	-	28	21H	5	6.0	M10×P1.25
PFYS-80-30	80	152.5	20.5	40	30	28	M16×P1.5	-	28	21H	5	6.0	M10×P1.25
PFYS-80-50	80	192.5	20.5	40	100	28	M16×P1.5	-	28	21H	5	6.0	M10×P1.25
PFYS-80-70	80	232.5	20.5	40	140	28	M16×P1.5	-	28	21H	5	6.0	M10×P1.25
PFYS-95-10	93	113	21	40	20	28	M16×P1.5	-	28	21H	5	6.0	M10×P1.25
PFYS-95-30	93	153	21	40	60	28	M16×P1.5	-	28	21H	5	6.0	M10×P1.25
PFYS-95-50	93	193	21	40	100	28	M16×P1.5	-	28	21H	5	6.0	M10×P1.25
PFYS-95-70	93	233	21	40	140	28	M16×P1.5	-	28	27H	5	6.0	M10×P1.25
PFYS-100-15	100	106	19	16	30	35	M22×P1.5	-	-	27H	6	6.0	-
PFYS-100-30	100	136	19	16	60	35	M22×P1.5	-	-	27H	6	6.0	-
PFYS-100-50	100	176	19	16	100	35	M22×P1.5	-	-	27H	6	6.0	-
PFYS-100-70	100	216	19	16	140	35	M22×P1.5	-	-	27H	6	6.0	-
PFYS-120-20	120	203.5	25.5	50	75	45	M30×P1.5	-	38	36H	10	6.0	4-M8
PFYS-120-100	120	239.5	25.5	50	165	45	M30×P1.5	-	38	36H	10	6.0	4-M8
PFYS-150-20	150	210.5	32.5	50	75	45	M30×P1.5	-	38	36H	10	9.0	4-M8
PFYS-150-100	150	300.5	32.5	50	165	45	M30×P1.5	-	38	36H	10	9.0	4-M8
PFYS-200-20	200	215.5	37.5	50	75	45	M30×P1.5	-	38	36H	10	13.0	4-M8
PFYS-200-100	200	305.5	37.5	50	165	45	M30×P1.5	-	38	36H	10	13.0	4-M8

# PFTKM/PFYKM系列

标准吸盘固定金属底座, 快速接管型



## 型号规格

**PF T KM - 2 - N**

①                      ②                      ③

①真空口方向

T - 垂直方向  
Y - 水平方向

②吸盘直径

2	10	35
3.5	15	40
5	20	50
6	25	
8	30	

③吸盘材质

N - 丁腈橡胶  
S - 硅橡胶  
NE - 导电性丁腈橡胶  
SE - 导电性硅橡胶

## 规格尺寸(mm)

垂直方向连接  
•PFTKM

适合吸盘直径  
Ø2·Ø3.5

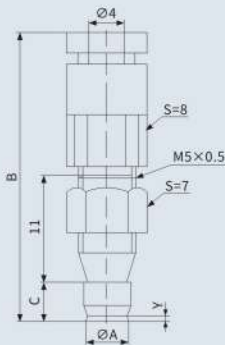

适合吸盘直径  
Ø5·Ø6·Ø8·Ø10

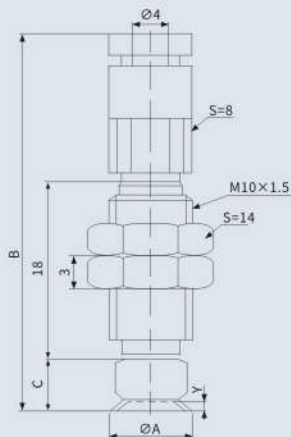

适合吸盘直径  
Ø15·Ø20·Ø25·Ø30·Ø35·Ø40·Ø50

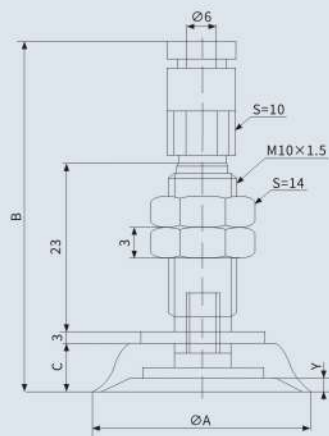

S:六角对边尺寸

型号	A	B	C	Y	Z
PFTKM-2	2	27.5	4	0.5	-
PFTKM-3.5	3.5	27.5	4	0.5	-
PFTKM-5	5	37.5	6.5	0.8	-
PFTKM-6	6	37.5	6.5	0.8	-
PFTKM-8	8	38	7	1.2	-
PFTKM-10	10	38.5	7.5	1.5	-
PFTKM-15	15	48	8	1.9	M5
PFTKM-20	20	50	10	2.3	M5
PFTKM-25	25	54	14	3	M6
PFTKM-30	30	52	12	2	M6
PFTKM-35	35	54	14	3	M6
PFTKM-40	40	54	14	3.5	M6
PFTKM-50	50	55	15	4	M6

吸盘及组件

HXD  
HOP  
HNP  
HNT  
SCG  
HXN  
HGP  
ZP  
ZP3  
ZP3E  
ZP3P  
ZP3P-JT3  
ZP3P-JT5  
MAF  
MAB  
MAOF  
MAOB  
BK  
PAG  
PATK/PAYK  
PATS  
PAYS  
PATKM/PAYKM  
PCG  
PCTK/PCYK  
PFG  
PFTK/PFYK  
PFTS  
PFYS  
PFTKM/PFYKM  
PJG  
PJTK/PJYK  
PJTS  
PJYS  
PJG  
PS  
PUG  
PUTK/PUYK  
PUTSB/PUYSB

## 规格尺寸(mm)

水平方向连接  
•PFYKM

适合吸盘直径  
Ø2·Ø3.5

适合吸盘直径  
Ø5·Ø6·Ø8·Ø10

适合吸盘直径  
Ø15·Ø20·Ø25·Ø30·Ø35·Ø40·Ø50

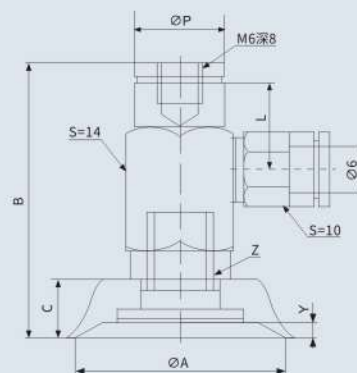
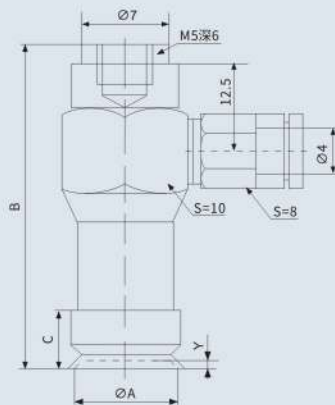
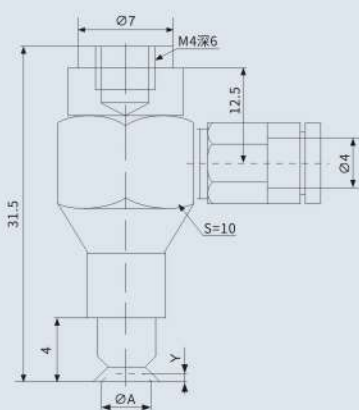

S:六角对边尺寸

型号	A	B	C	L	Y	Y	Z
PFYKM-2	2	-	-	-	-	0.5	-
PFYKM-3.5	3.5	-	-	-	-	0.5	-
PFYKM-5	5	37.5	6.5	-	-	0.8	-
PFYKM-6	6	37.5	6.5	-	-	0.8	-
PFYKM-8	8	38	7	-	-	1.2	-
PFYKM-10	10	38.5	7.5	-	-	1.5	-
PFYKM-15	15	48	8	14	9	1.9	M5
PFYKM-20	20	50	10	14	9	2.3	M5
PFYKM-25	25	54	14	20	12	3	M6
PFYKM-30	30	52	12	20	12	2	M6
PFYKM-35	35	54	14	20	12	3	M6
PFYKM-40	40	54	14	20	12	3.5	M6
PFYKM-50	50	55	15	20	12	4	M6

# PJG系列

双层吸盘



## 产品特点

- \*唇部薄,与特件的密封性好。
- \*适用于吸附有倾斜的物件和小尺寸的纸条、塑料膜等。
- \*吸附能力强大,稳定。

## 型号规格

PJG - 6 - N

①

②

### ①吸盘直径

4	20	50
6	25	60
8	30	70
10	35	80
15	40	

### ②吸盘材质

N - 丁腈橡胶  
S - 硅橡胶  
NE - 导电性丁腈橡胶  
SE - 导电性硅橡胶

## 规格尺寸(mm)

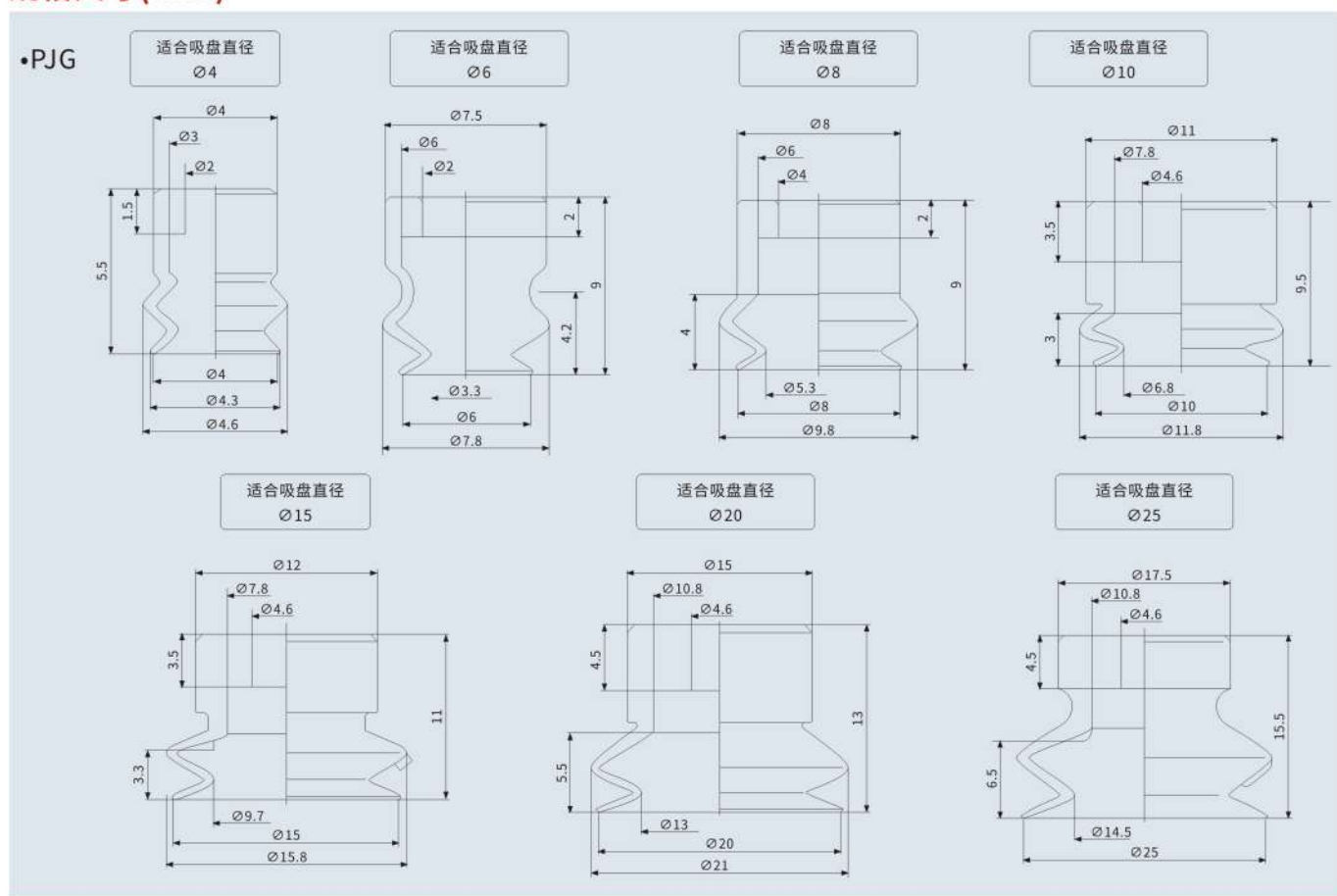

**吸盘及组件**

- HXD
- HOP
- HNP
- HNT
- SCG
- HXN
- HGP
- ZP
- ZP3
- ZP3E
- ZP3P
- ZP3P-JT3
- ZP3P-JT5
- MAF
- MAB
- MAOF
- MAOB
- BK
- PAG
- PATK/PAYK
- PATS
- PAYS
- PATKM/PAYKM
- PCG
- PCTK/PCYK
- PFG
- PFTK/PFYK
- PFTS
- PFYS
- PFTKM/PFYKM
- PJG**
- PJTK/PJYK
- PJTS
- PJYS
- PJG
- PS
- PUG
- PUTK/PUYK
- PUTSB/PUYSB

规格尺寸(mm)

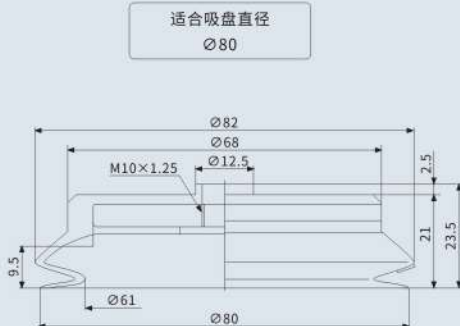
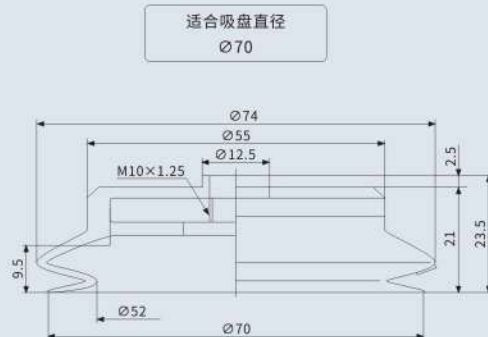
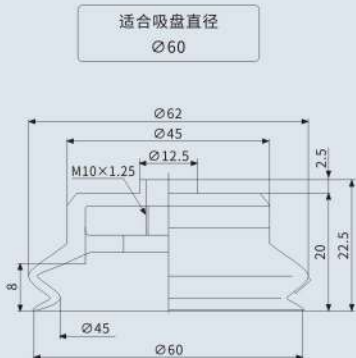
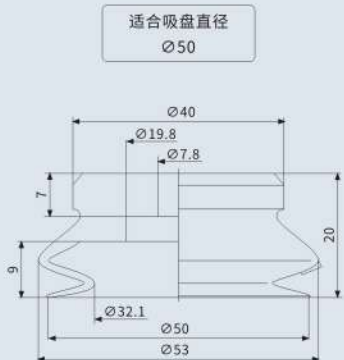
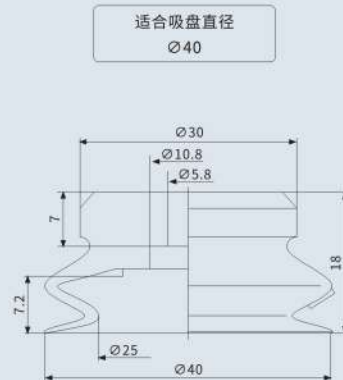
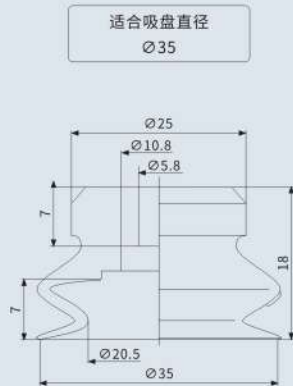
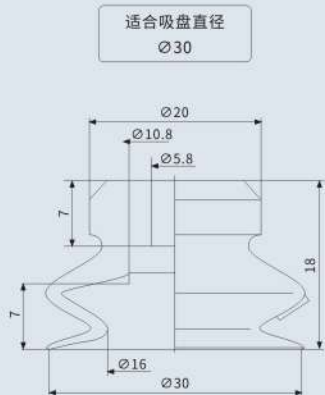

S:六角对边尺寸



# PJTK/PJYK系列

双层吸盘固定金属底座



## 型号规格

PJ T K - 6 - N  
① ② ③

### ①真空口方向

T - 垂直方向  
Y - 水平方向

### ②吸盘直径

6	20	40	80
8	25	50	
10	30	60	
15	35	70	

### ③吸盘材质

N - 丁腈橡胶  
S - 硅橡胶  
NE - 导电性丁腈橡胶  
SE - 导电性硅橡胶

## 规格尺寸(mm)

### 垂直方向连接 •PJTK



S:六角对边尺寸

型号	A	B	D	E	F	J	S	Y	Z
PJTK-6	6	33	14	-	M9	-	12H	4.2	-
PJTK-8	8	33	14	-	M9	-	12H	4.2	-
PJTK-10	10	47.5	22	10H	M8	15	10H	3	M5
PJTK-15	15	49	22	10H	M8	15	10H	4.5	M5
PJTK-20	20	51	22	10H	M8	15	10H	5.5	M5
PJTK-25	25	63.5	32	14H	M10	20	14H	6.5	M6
PJTK-30	30	66	32	14H	M10	20	14H	8	M6
PJTK-35	35	66	32	14H	M10	20	14H	8	M6
PJTK-40	40	66	32	14H	M10	20	14H	8	M6
PJTK-50	50	68	32	14H	M10	20	14H	9	M8
PJTK-60	60	62.5	40	21H	M16	23	21H	10	M10
PJTK-70	70	63.5	40	22H	M16	23	21H	11	M10
PJTK-80	80	63.5	40	23H	M16	23	21H	11	M10

### 水平方向连接 •PJYK

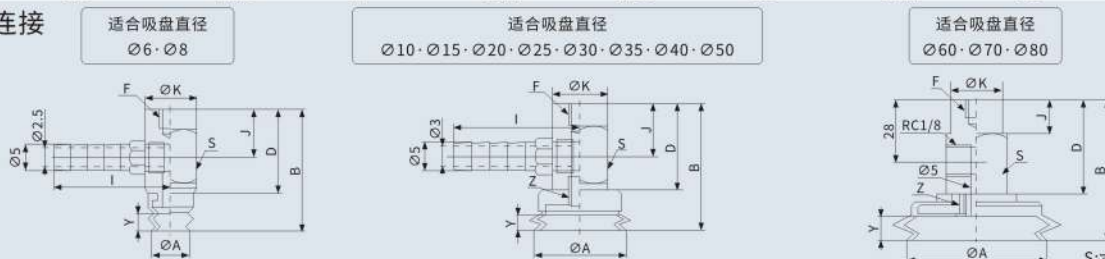

S:六角对边尺寸

型号	A	B	D	I	S	F	J	K	Y	Z
PJYK-6	6	31.5	22.5	21	10H	M4深6	13	10	4.2	-
PJYK-8	8	31.5	22.5	21	10H	M4深6	13	10	4.2	-
PJYK-10	10	31.5	22	21	10H	M4深6	14	10	3	M5
PJYK-15	15	33	22	21	10H	M4深6	14	10	4.5	M5
PJYK-20	20	35	22	21	10H	M4深6	14	10	5.5	M5
PJYK-25	25	47.5	32	23	14H	M6深8	20	12	6.5	M6
PJYK-30	30	50	32	23	14H	M6深8	20	12	8	M6
PJYK-35	30	50	32	23	14H	M6深8	20	12	8	M6
PJYK-40	40	50	32	23	14H	M6深8	20	12	8	M6
PJYK-50	50	52	32	23	14H	M6深8	20	12	9	M6
PJYK-60	60	62.5	32	-	21H	M8深11	18	17	10	M10
PJYK-70	70	63.5	32	-	21H	M8深11	18	17	11	M10
PJYK-80	80	63.5	32	-	21H	M8深11	18	17	11	M10

## 吸盘及组件

- HXD
- HOP
- HNP
- HNT
- SCG
- HXN
- HGP
- ZP
- ZP3
- ZP3E
- ZP3P
- ZP3P-JT3
- ZP3P-JT5
- MAF
- MAB
- MAOF
- MAOB
- BK
- PAG
- PATK/PAYK
- PATS
- PAYS
- PATKM/PAYKM
- PCG
- PCTK/PCYK
- PFG
- PFTK/PFYK
- PFTS
- PFYS
- PFTKM/PFYKM
- PJG
- PJTK/PJYK
- PJTS
- PJYS
- PJG
- PS
- PUG
- PUTK/PUYK
- PUTSB/PUYSB



**型号规格**

**PJTS - 6 - 3 - N**  
①                      ②                      ③

①吸盘直径		②行程		③吸盘材质
6	35	3	20	N - 丁腈橡胶
8	40	4	25	S - 硅橡胶
10	50	6	30	NE - 导电性丁腈橡胶
15	60	10	50	SE - 导电性硅橡胶
20	70			
25	80			
30				

**规格尺寸(mm)**

垂直方向连接  
•PJTS

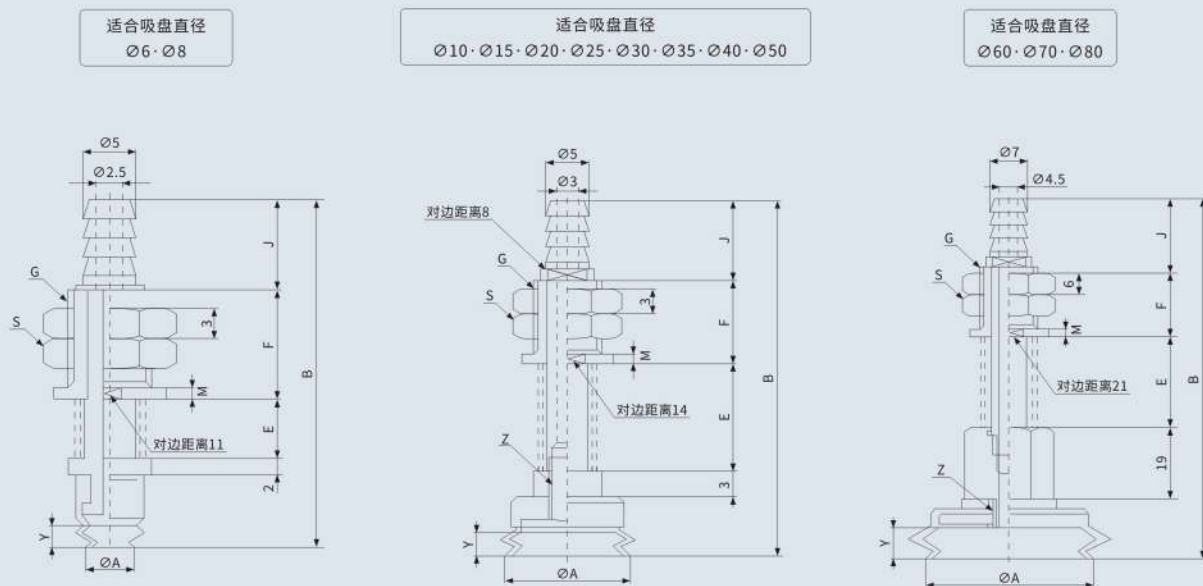

S:六角对边尺寸

型号	A	B	E	F	G	J	S	M	Y	Z
PJTS-6-3	6	40	6	13	M9×P1	10	12H	2	4.2	-
PJTS-6-10	6	54	20	13	M9×P1	10	12H	2	4.2	-
PJTS-6-15	6	64	30	13	M9×P1	10	12H	2	4.2	-
PJTS-6-25	6	84	50	13	M9×P1	10	12H	2	4.2	-
PJTS-8-3	8	40	6	13	M9×P1	10	12H	2	4.2	-
PJTS-8-10	8	54	20	13	M9×P1	10	12H	2	4.2	-
PJTS-8-15	8	64	30	13	M9×P1	10	12H	2	4.2	-
PJTS-8-25	8	84	50	13	M9×P1	10	12H	2	4.2	-
PJTS-10-4	10	55.5	8	19	M11×P1	16	14H	3	3	M5
PJTS-10-10	10	67.5	20	19	M11×P1	16	14H	3	3	M5
PJTS-10-20	10	87.5	40	19	M11×P1	16	14H	3	3	M5
PJTS-10-30	10	107.5	60	19	M11×P1	16	14H	3	3	M5
PJTS-15-4	15	57	8	19	M11×P1	16	14H	3	4.5	M5
PJTS-15-10	15	69	20	19	M11×P1	16	14H	3	4.5	M5
PJTS-15-20	15	89	40	19	M11×P1	16	14H	3	4.5	M5
PJTS-15-30	15	109	60	19	M11×P1	16	14H	3	4.5	M5
PJTS-20-4	20	59	8	19	M11×P1	16	14H	3	5.5	M5
PJTS-20-10	20	71	20	19	M11×P1	16	14H	3	5.5	M5
PJTS-20-20	20	91	40	19	M11×P1	16	14H	3	5.5	M5
PJTS-20-30	20	111	60	19	M11×P1	16	14H	3	5.5	M5
PJTS-30-6	30	75	13	24	M14×P1.5	17	17H	4	8	M6
PJTS-30-15	30	92	30	24	M14×P1.5	17	17H	4	8	M6
PJTS-30-30	30	122	60	24	M14×P1.5	17	17H	4	8	M6
PJTS-30-50	30	162	100	24	M14×P1.5	17	17H	4	8	M6
PJTS-40-6	40	75	13	24	M14×P1.5	17	17H	4	8	M6
PJTS-40-15	40	92	30	24	M14×P1.5	17	17H	4	8	M6
PJTS-40-30	40	122	60	24	M14×P1.5	17	17H	4	8	M6
PJTS-40-50	40	162	100	24	M14×P1.5	17	17H	4	8	M6
PJTS-50-6	50	77	20	24	M14×P1.5	17	17H	4	9	M6
PJTS-50-15	50	94	60	24	M14×P1.5	17	17H	4	9	M6
PJTS-50-30	50	124	100	24	M14×P1.5	17	17H	4	9	M6
PJTS-50-50	50	164	140	24	M14×P1.5	17	17H	4	9	M6
PJTS-60-10	60	114.5	20	28	M16×P1.5	28	21H	5	10	M10
PJTS-60-30	60	154.5	60	28	M16×P1.5	28	21H	5	10	M10
PJTS-60-50	60	194.5	100	28	M16×P1.5	28	21H	5	10	M10
PJTS-60-70	60	234.5	140	28	M16×P1.5	28	21H	5	10	M10
PJTS-70-10	70	115.5	20	28	M16×P1.5	28	21H	5	11	M10
PJTS-70-30	70	155.5	60	28	M16×P1.5	28	21H	5	11	M10
PJTS-70-50	70	195.5	100	28	M16×P1.5	28	21H	5	11	M10
PJTS-70-70	70	235.5	140	28	M16×P1.5	28	21H	5	11	M10
PJTS-80-10	80	115.5	20	28	M16×P1.5	28	21H	5	11	M10
PJTS-80-30	80	155.5	60	28	M16×P1.5	28	21H	5	11	M10
PJTS-80-50	80	195.5	100	28	M16×P1.5	28	21H	5	11	M10
PJTS-80-70	80	235.5	140	28	M16×P1.5	28	21H	5	11	M10

- HXD
- HOP
- HNP
- HNT
- SCG
- HXN
- HGP
- ZP
- ZP3
- ZP3E
- ZP3P
- ZP3P-JT3
- ZP3P-JT5
- MAF
- MAB
- MAOF
- MAOB
- BK
- PAG
- PATK/PAYK
- PATS
- PAYS
- PATKM/PAYKM
- PCG
- PCTK/PCYK
- PFG
- PFTK/PFYK
- PFTS
- PFYS
- PFTKM/PFYKM
- PJG
- PJTK/PJYK
- PJTS**
- PJYS
- PJG
- PS
- PUG
- PUTK/PUYK
- PUTSB/PUYSB



**型号规格**

**PJYS - 6 - 3 - N**  
①                      ②                      ③

①吸盘直径		②行程		③吸盘材质
6	35	3	20	N - 丁腈橡胶
8	40	4	25	S - 硅橡胶
10	50	6	30	NE - 导电性丁腈橡胶
15	60	10	50	SE - 导电性硅橡胶
20	70			
25	80			
30				

**规格尺寸(mm)**

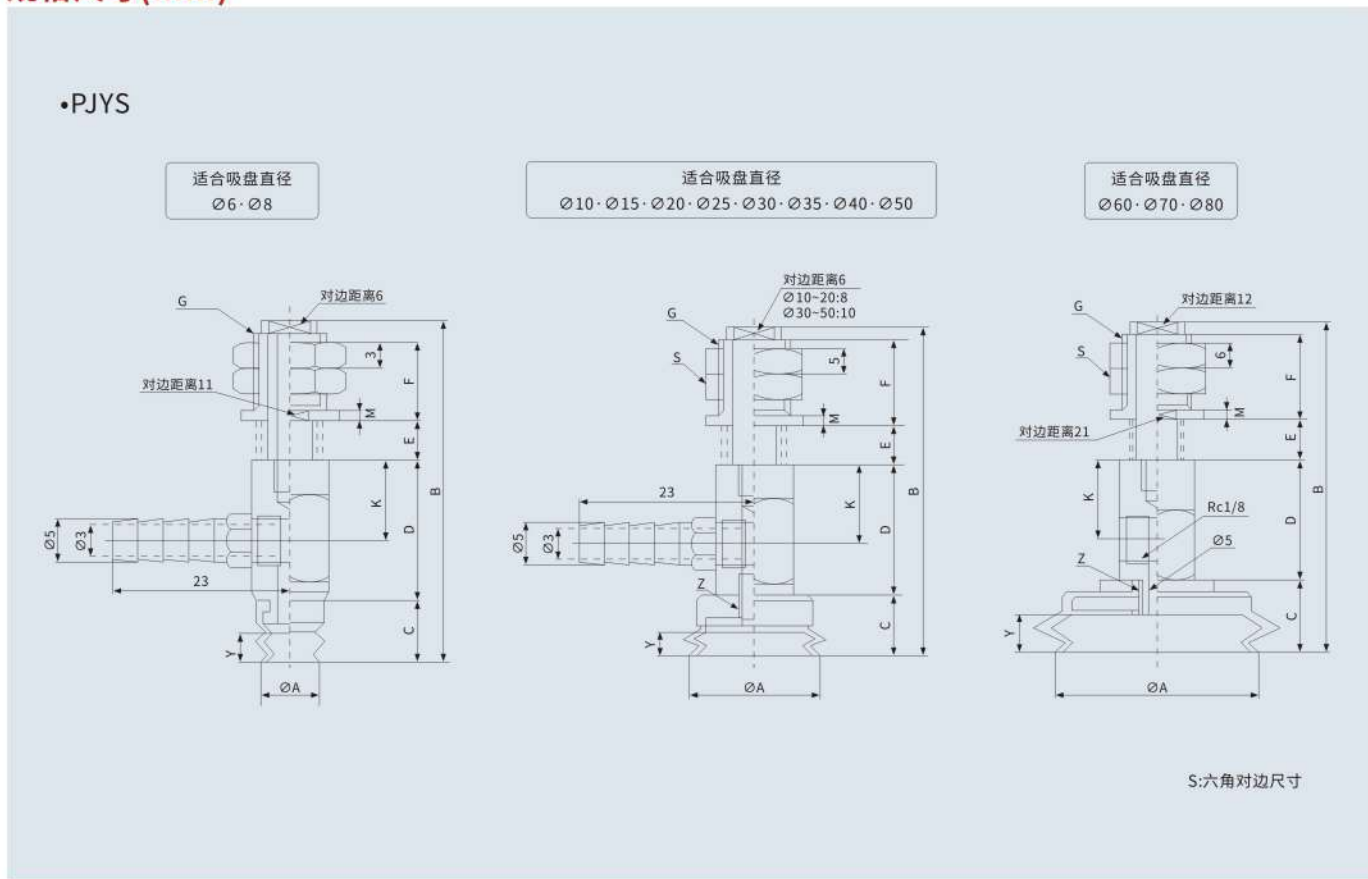



型号	A	B	C	D	E	F	G	K	S	M	Y	Z
PJYS-6-3	6	53.5	9	22.5	6	13	M9×P1	13	-	2	4.2	-
PJYS-6-10	6	67.5	9	22.5	20	13	M9×P1	13	-	2	4.2	-
PJYS-6-15	6	77.5	9	22.5	30	13	M9×P1	13	-	2	4.2	-
PJYS-6-25	6	97.5	9	22.5	50	13	M9×P1	13	-	2	4.2	-
PJYS-8-3	8	53.5	9	22.5	6	13	M9×P1	13	-	2	4.2	-
PJYS-8-10	8	67.5	9	22.5	20	13	M9×P1	13	-	2	4.2	-
PJYS-8-15	8	77.5	9	22.5	30	13	M9×P1	13	-	2	4.2	-
PJYS-8-25	8	97.5	9	22.5	50	13	M9×P1	13	-	2	4.2	-
PJYS-10-4	10	61.5	9.5	22	8	19	M11×P1	14	14H	3	3	M5
PJYS-10-10	10	73.5	9.5	22	20	19	M11×P1	14	14H	3	3	M5
PJYS-10-20	10	93.5	9.5	22	40	19	M11×P1	14	14H	3	3	M5
PJYS-10-30	10	113.5	9.5	22	60	19	M11×P1	14	14H	3	3	M5
PJYS-15-4	15	63	11	22	8	19	M11×P1	14	14H	3	4.5	M5
PJYS-15-10	15	75	11	22	20	19	M11×P1	14	14H	3	4.5	M5
PJYS-15-20	15	95	11	22	40	19	M11×P1	14	14H	3	4.5	M5
PJYS-15-30	15	115	11	22	60	19	M11×P1	14	14H	3	4.5	M5
PJYS-20-4	20	65	13	22	8	19	M11×P1	14	14H	3	5.5	M5
PJYS-20-10	20	77	13	22	20	19	M11×P1	14	14H	3	5.5	M5
PJYS-20-20	20	97	13	22	40	19	M11×P1	14	14H	3	5.5	M5
PJYS-20-30	20	117	13	22	60	19	M11×P1	14	14H	3	5.5	M5
PJYS-30-6	30	91	18	32	13	24	M14×P1.5	20	17H	4	8	M6
PJYS-30-15	30	108	18	32	30	24	M14×P1.5	20	17H	4	8	M6
PJYS-30-30	30	138	18	32	60	24	M14×P1.5	20	17H	4	8	M6
PJYS-30-50	30	178	18	32	100	24	M14×P1.5	20	17H	4	8	M6
PJYS-40-6	40	91	18	32	13	24	M14×P1.5	20	17H	4	8	M6
PJYS-40-15	40	108	18	32	30	24	M14×P1.5	20	17H	4	8	M6
PJYS-40-30	40	138	18	32	60	24	M14×P1.5	20	17H	4	8	M6
PJYS-40-50	40	178	18	32	100	24	M14×P1.5	20	17H	4	8	M6
PJYS-50-6	50	93	20	32	13	24	M14×P1.5	20	17H	4	9	M6
PJYS-50-15	50	110	20	32	30	24	M14×P1.5	20	17H	4	9	M6
PJYS-50-30	50	140	20	32	60	24	M14×P1.5	20	17H	4	9	M6
PJYS-50-50	50	180	20	32	100	24	M14×P1.5	20	17H	4	9	M6
PJYS-60-10	60	114.5	22.5	32	20	28	M14×P1.5	28	21H	5	10	M10×P1.25
PJYS-60-30	60	154.5	22.5	32	60	28	M14×P1.5	28	21H	5	10	M10×P1.25
PJYS-60-50	60	194.5	22.5	32	100	28	M14×P1.5	28	21H	5	10	M10×P1.25
PJYS-60-70	60	234.5	22.5	32	140	28	M14×P1.5	28	21H	5	10	M10×P1.25
PJYS-70-10	70	115.5	23.5	32	20	28	M14×P1.5	28	21H	5	11	M10×P1.25
PJYS-70-30	70	155.5	23.5	32	60	28	M14×P1.5	28	21H	5	11	M10×P1.25
PJYS-70-50	70	195.5	23.5	32	100	28	M14×P1.5	28	21H	5	11	M10×P1.25
PJYS-70-70	70	235.5	23.5	32	140	28	M14×P1.5	28	21H	5	11	M10×P1.25
PJYS-80-10	80	115.5	23.5	32	20	28	M14×P1.5	28	21H	5	11	M10×P1.25
PJYS-80-30	80	155.5	23.5	32	60	28	M14×P1.5	28	21H	5	11	M10×P1.25
PJYS-80-50	80	195.5	23.5	32	100	28	M14×P1.5	28	21H	5	11	M10×P1.25
PJYS-80-70	80	235.5	23.5	32	140	28	M14×P1.5	28	21H	5	11	M10×P1.25

- HXD
- HOP
- HNP
- HNT
- SCG
- HXN
- HGP
- ZP
- ZP3
- ZP3E
- ZP3P
- ZP3P-JT3
- ZP3P-JT5
- MAF
- MAB
- MAOF
- MAOB
- BK
- PAG
- PATK/PAYK
- PATS
- PAYS
- PATKM/PAYKM
- PCG
- PCTK/PCYK
- PFG
- PFTK/PFYK
- PFTS
- PFYS
- PFTKM/PFYKM
- PJG
- PJTK/PJYK
- PJTS
- PJYS**
- PJG
- PS
- PUG
- PUTK/PUYK
- PUTSB/PUYSB





**产品特点**

- \* PJK吸盘用的盘芯, 在原有的褶皱吸盘PJK的基础上, 安装了PEEK制的配件。
- \* 防止了静电的产生, 防止了橡胶制的吸盘对吸附物的粘贴, 以防止吸附痕迹的产生。

**型号规格**

**PJK - 8 - N - PEEK**

①                      ②

①适用吸盘		②吸盘材质
8 - PJK-8	30 - PJK-30	N - 丁腈橡胶
10 - PJK-8	35 - PJK-35	S - 硅橡胶
15 - PJK-8	40 - PJK-40	NE - 导电性丁腈橡胶
20 - PJK-8	50 - PJK-50	SE - 导电性硅橡胶
25 - PJK-8		

**规格尺寸(mm)**

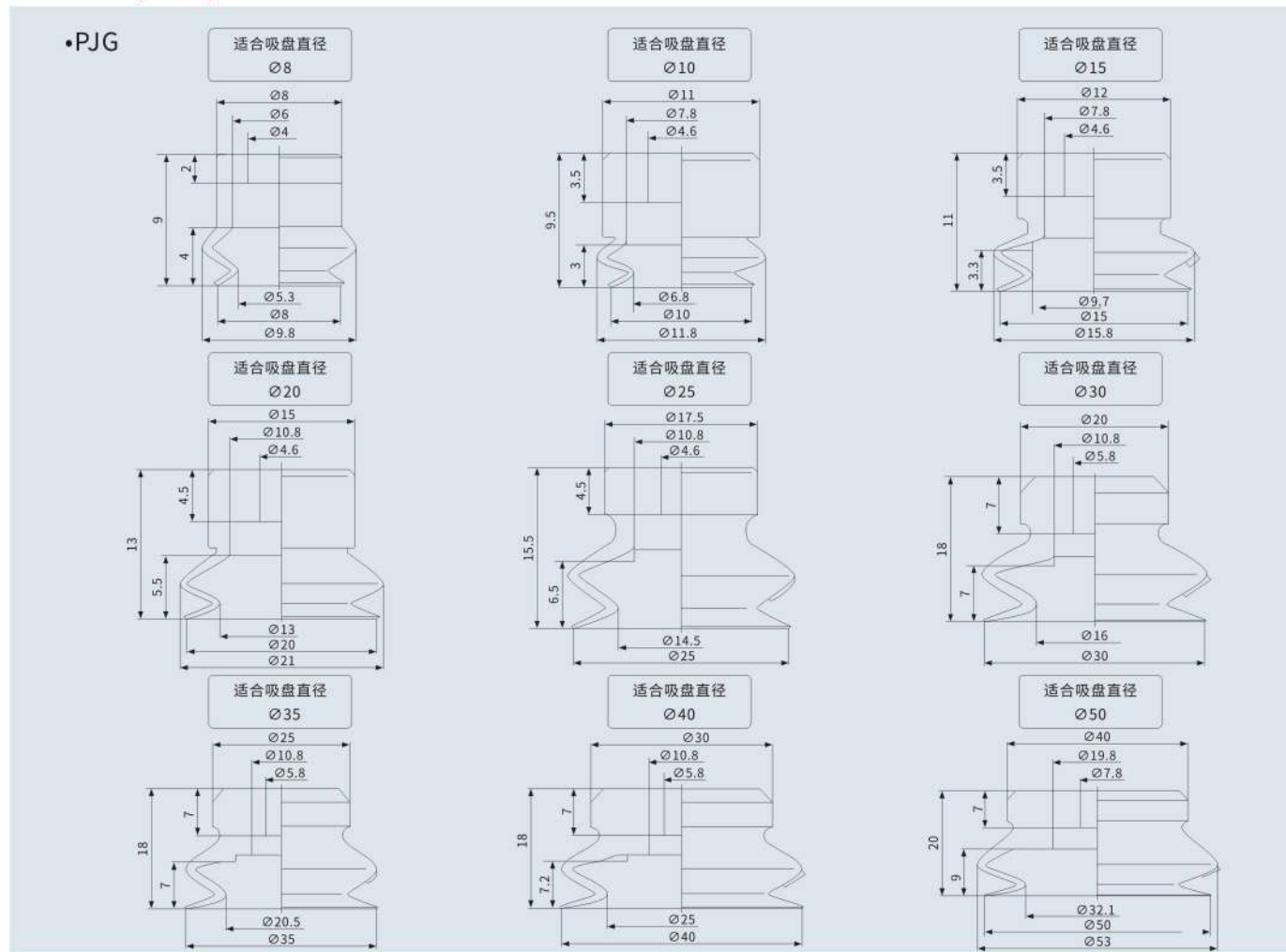



型号	A	B	H	Y
PS-6-M	6	14.5	2	0.8
PS-8-M	8	15	2	1.2
PS-10-M	10	15.5	2	1.5
PS-15-M	15	22	2	1.9
PS-20-M	20	24	3	2.3
PS-25-M	25	28	3	3.0
PS-30-M	30	26	3	2.0
PS-35-M	35	28	3	3.0
PS-40-M	40	28	3	3.5
PS-50-M	50	29	4	4.0
PS-6-J-M	6	17	2	4.2
PS-8-J-M	8	17	2	4.0
PS-10-J-M	10	17.5	2	3.0
PS-15-J-M	15	25	2	3.3
PS-20-J-M	20	27	2	5.5
PS-30-J-M	30	32	3	7.0
PS-40-J-M	40	32	3	7.2
PS-50-J-M	50	34	4	9.0
PS-6-F	6	14.5	2	0.8
PS-8-F	8	15	2	1.2
PS-10-F	10	15.5	2	1.5
PS-15-F	15	22	2	1.9
PS-20-F	20	24	3	2.3
PS-25-F	25	28	3	3.0
PS-30-F	30	26	3	2.0
PS-35-F	35	28	3	3.0
PS-40-F	40	28	3	3.5
PS-50-F	50	29	4	4.0

•PS-J-F

适合吸盘直径  
Ø6·Ø8

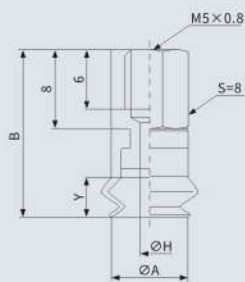

适合吸盘直径  
Ø10

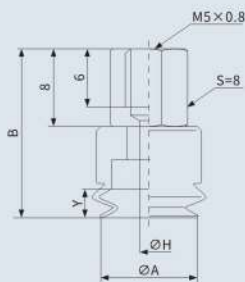

适合吸盘直径  
Ø15·Ø20·Ø30·Ø40·Ø50

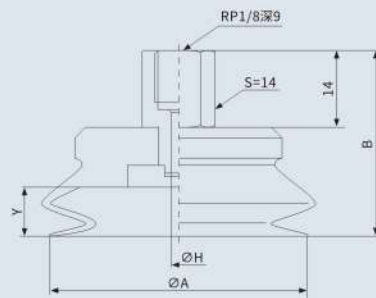

S:六角对边尺寸

型号	A	B	H	Y
PS-6-J-F	6	17	2	4.2
PS-8-J-F	8	17	2	4
PS-10-J-F	10	17.5	2	3
PS-15-J-F	15	25	2	3.3
PS-20-J-F	20	27	3	5.5
PS-30-J-F	30	32	3	7
PS-40-J-F	40	32	3	7.2
PS-50-J-F	50	34	4	9



## 产品特点

- \* 平行方向吸盘
- \* 特殊盘面结构设计, 吸住稳定。

## 型号规格

**PUG - 80 - N**

①

②

### ①吸盘直径

10	50
15	60
20	80
25	100
30	120
35	150
40	200

### ②吸盘材质

- N** - 丁腈橡胶
- S** - 硅橡胶
- NE** - 导电性丁腈橡胶
- SE** - 导电性硅橡胶

## 规格尺寸(mm)

### •PUG

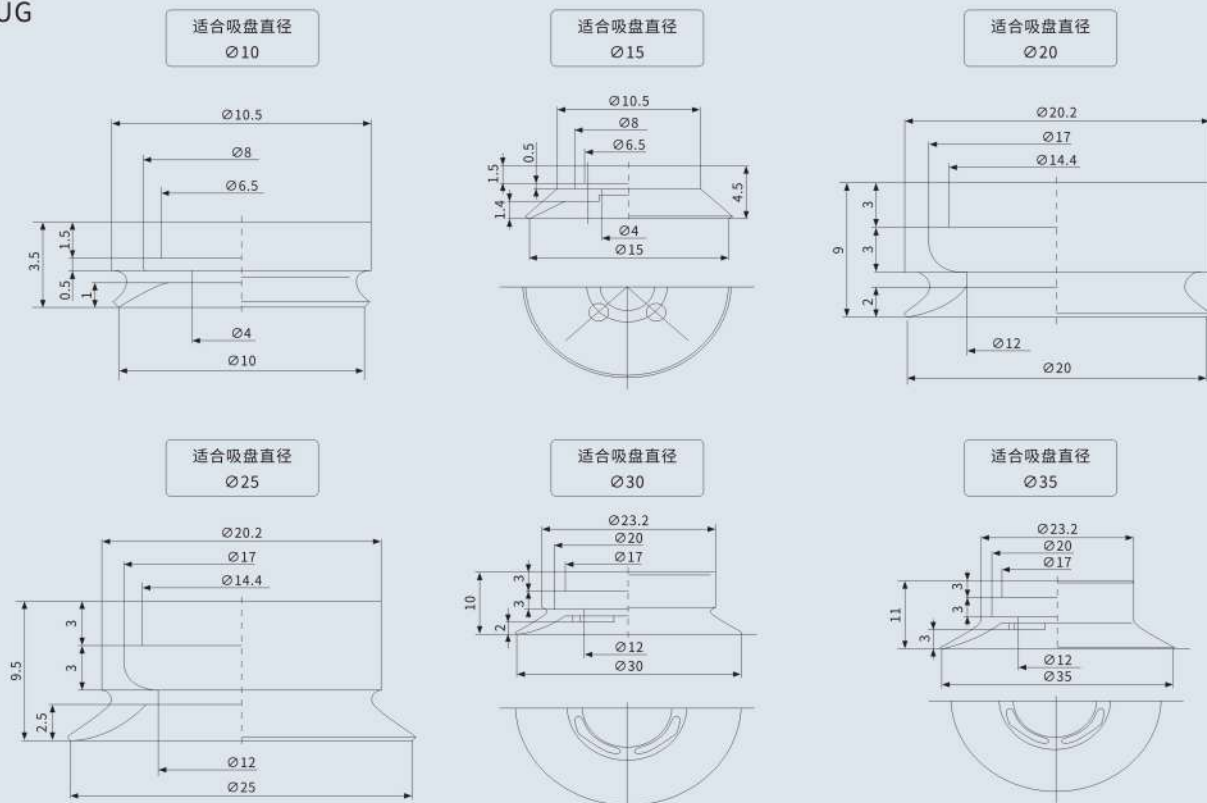

规格尺寸(mm)

适合吸盘直径  
Ø40

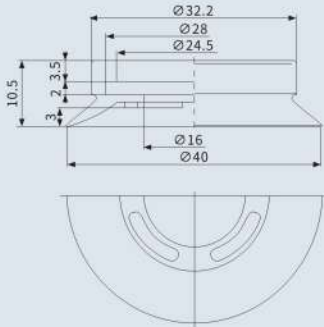

适合吸盘直径  
Ø50

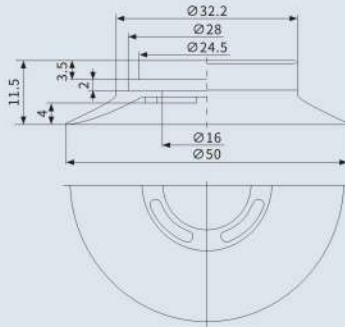

适合吸盘直径  
Ø60

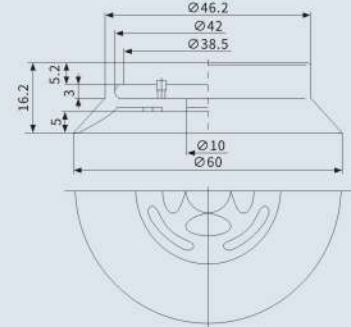

适合吸盘直径  
Ø80

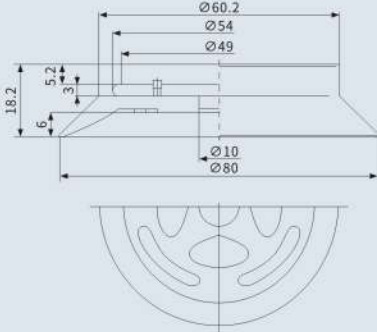

适合吸盘直径  
Ø100

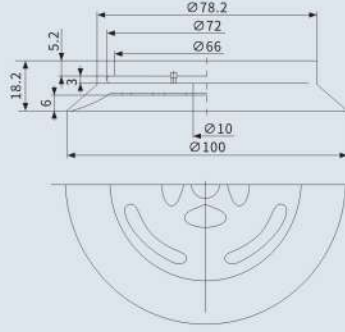

适合吸盘直径  
Ø120

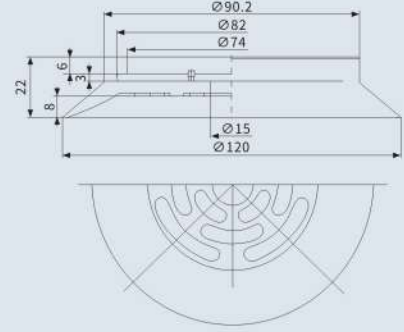

适合吸盘直径  
Ø150

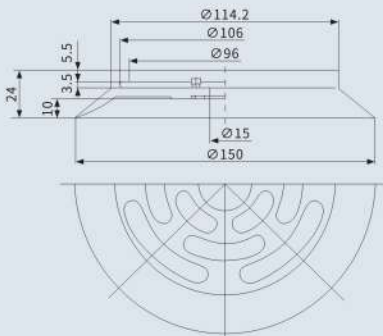

适合吸盘直径  
Ø200

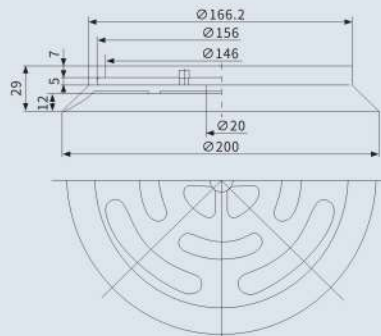

S:六角对边尺寸



# PUTK/PUYK系列

摇摆型吸盘附固定式金属底座



## 型号规格

PU T K - 80 - N

①

②

③

### ①真空口方向

T - 垂直方向  
Y - 水平方向

### ②吸盘直径

10	50
15	60
20	80
25	100
30	120
35	150
40	200

### ③吸盘材质

N - 丁腈橡胶  
S - 硅橡胶  
NE - 导电性丁腈橡胶  
SE - 导电性硅橡胶

## 吸盘及组件

HXD

HOP

HNP

HNT

SCG

HXN

HGP

ZP

ZP3

ZP3E

ZP3P

ZP3P-JT3

ZP3P-JT5

MAF

MAB

MAOF

MAOB

BK

PAG

PATK/PAYK

PATS

PAYS

PATKM/PAYKM

PCG

PCTK/PCYK

PFG

PFTK/PFYK

PFTS

PFYS

PFTKM/PFYKM

PJG

PJTK/PJYK

PJTS

PJYS

PJG

PS

PUG

**PUTK/PUYK**

PUTSB/PUYSB

## 规格尺寸(mm)

垂直方向连接  
•PUTK

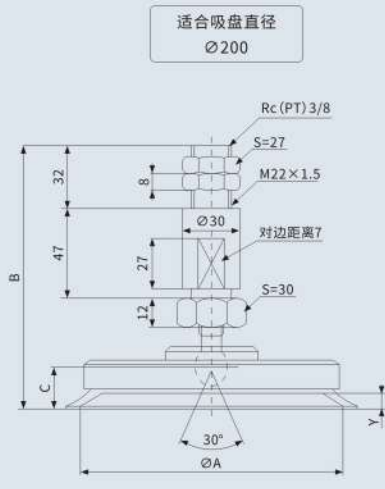
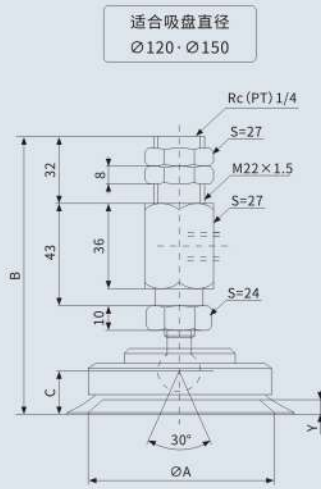
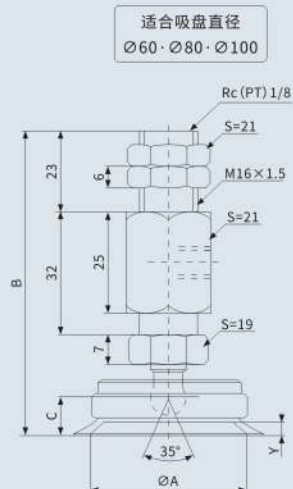
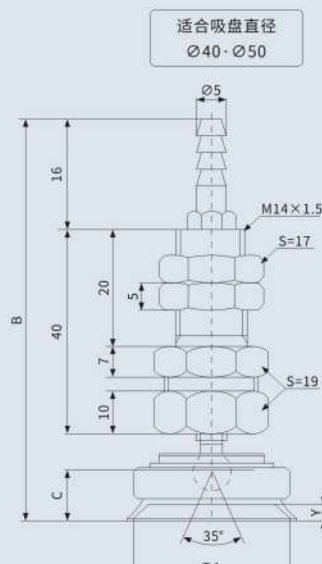
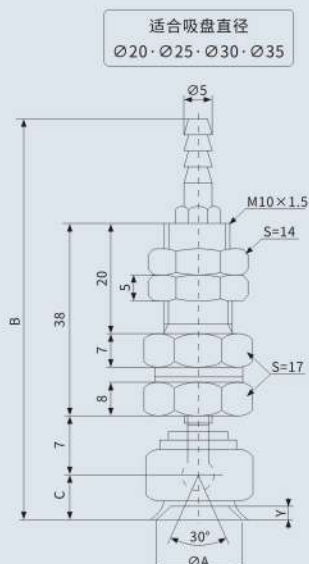
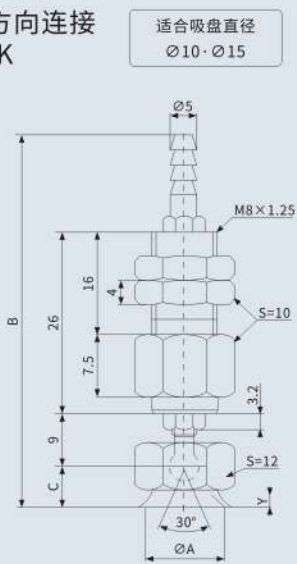

S:六角对边尺寸

型号	A	B	C	Y
PUTK-10	10	56	5	1
PUTK-15	15	57	6	1.4
PUTK-20	20	70	9	2
PUTK-25	25	70.5	9.5	2.5
PUTK-30	30	71	10	2
PUTK-35	35	72	11	3
PUTK-40	40	77	11	3
PUTK-50	50	78	12	4
PUTK-60	60	93	16	5
PUTK-80	80	95	18	6
PUTK-100	100	95	18	6
PUTK-120	120	128	23	8
PUTK-150	150	130	25	10
PUTK-200	200	140	29	12

**规格尺寸(mm)**

水平方向连接  
•PUYK

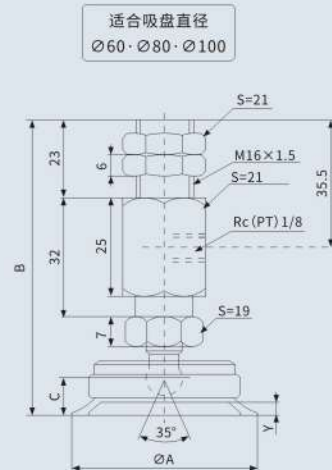
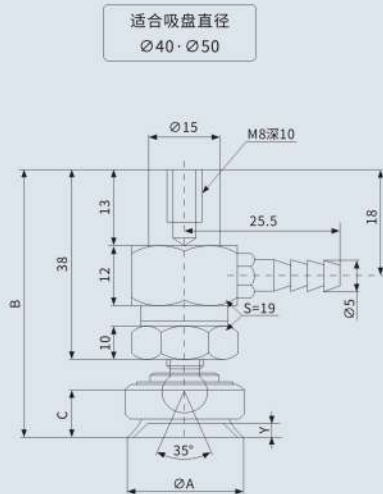
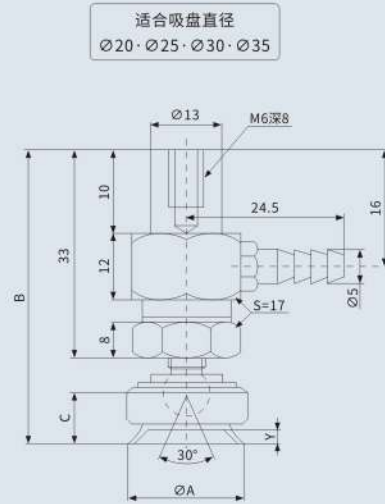
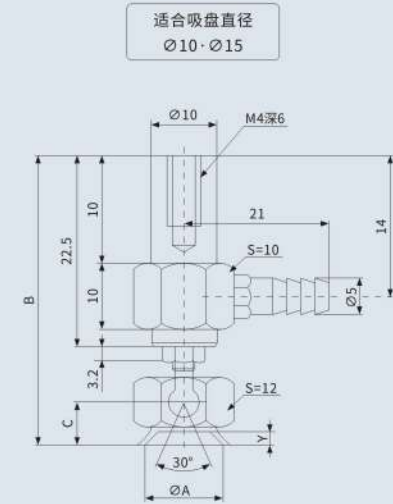

规格尺寸(mm)

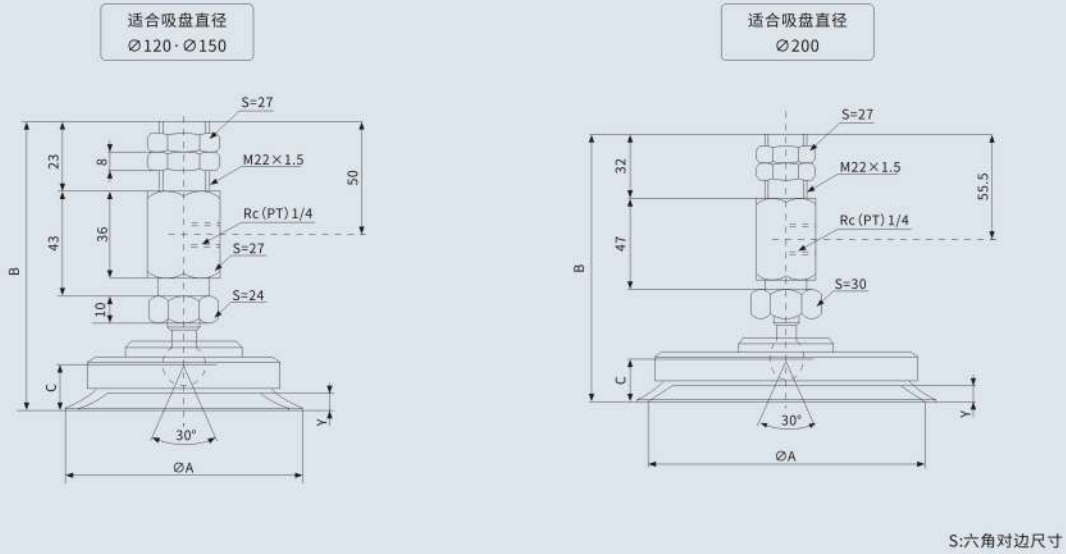

型号	A	B	E	Y
PUYK-10	10	36.5	5	1
PUYK-15	15	37.5	6	1.4
PUYK-20	20	49	9	2
PUYK-25	25	49.5	9.5	2.5
PUYK-30	30	50	10	2
PUYK-35	35	51	11	3
PUYK-40	40	59	11	3
PUYK-50	50	60	12	4
PUYK-60	60	93	16	5
PUYK-80	80	95	18	6
PUYK-100	100	95	18	6
PUYK-120	120	128	23	8
PUYK-150	150	130	25	10
PUYK-200	200	140	29	12

吸盘及组件

- HXD
- HOP
- HNP
- HNT
- SCG
- HXN
- HGP
- ZP
- ZP3
- ZP3E
- ZP3P
- ZP3P-JT3
- ZP3P-JT5
- MAF
- MAB
- MAOF
- MAOB
- BK
- PAG
- PATK/PAYK
- PATS
- PAYS
- PATKM/PAYKM
- PCG
- PCTK/PCYK
- PFG
- PFTK/PFYK
- PFTS
- PFYS
- PFTKM/PFYKM
- PJG
- PJTK/PJYK
- PJTS
- PJYS
- PJG
- PS
- PUG
- PUTK/PUYK
- PUTSB/PUYSB



型号	A	B	C	E	Y
PUTSB-25-6	25	87	9.5	13	2.5
PUTSB-25-15	25	104	9.5	30	2.5
PUTSB-25-30	25	134	9.5	60	2.5
PUTSB-25-50	25	174	9.5	100	2.5
PUTSB-30-6	30	87.5	10	13	2.0
PUTSB-30-15	30	104.5	10	30	2.0
PUTSB-30-30	30	134.5	10	60	2.0
PUTSB-30-50	30	174.5	10	100	2.0
PUTSB-35-6	35	88.5	11	13	3.0
PUTSB-35-15	35	105.5	11	30	3.0
PUTSB-35-30	35	135.5	11	60	3.0
PUTSB-35-50	35	175.5	11	100	3.0
PUTSB-40-6	40	97.5	11	13	3.0
PUTSB-40-15	40	114.5	11	30	3.0
PUTSB-40-30	40	144.5	11	60	3.0
PUTSB-40-50	40	184.5	11	100	3.0
PUTSB-50-6	50	98.5	12	13	4.0
PUTSB-50-15	50	115.5	12	30	4.0
PUTSB-50-30	50	145.5	12	60	4.0
PUTSB-50-50	50	185.5	12	100	4.0

## 吸盘及组件

- HXD
- HOP
- HNP
- HNT
- SCG
- HXN
- HGP
- ZP
- ZP3
- ZP3E
- ZP3P
- ZP3P-JT3
- ZP3P-JT5
- MAF
- MAB
- MAOF
- MAOB
- BK
- PAG
- PATK/PAYK
- PATS
- PAYS
- PATKM/PAYKM
- PCG
- PCTK/PCYK
- PFG
- PFTK/PFYK
- PFTS
- PFYS
- PFTKM/PFYKM
- PJG
- PJTK/PJYK
- PJTS
- PJYS
- PJG
- PS
- PUG
- PUTK/PUYK
- PUTSB/PUYSB

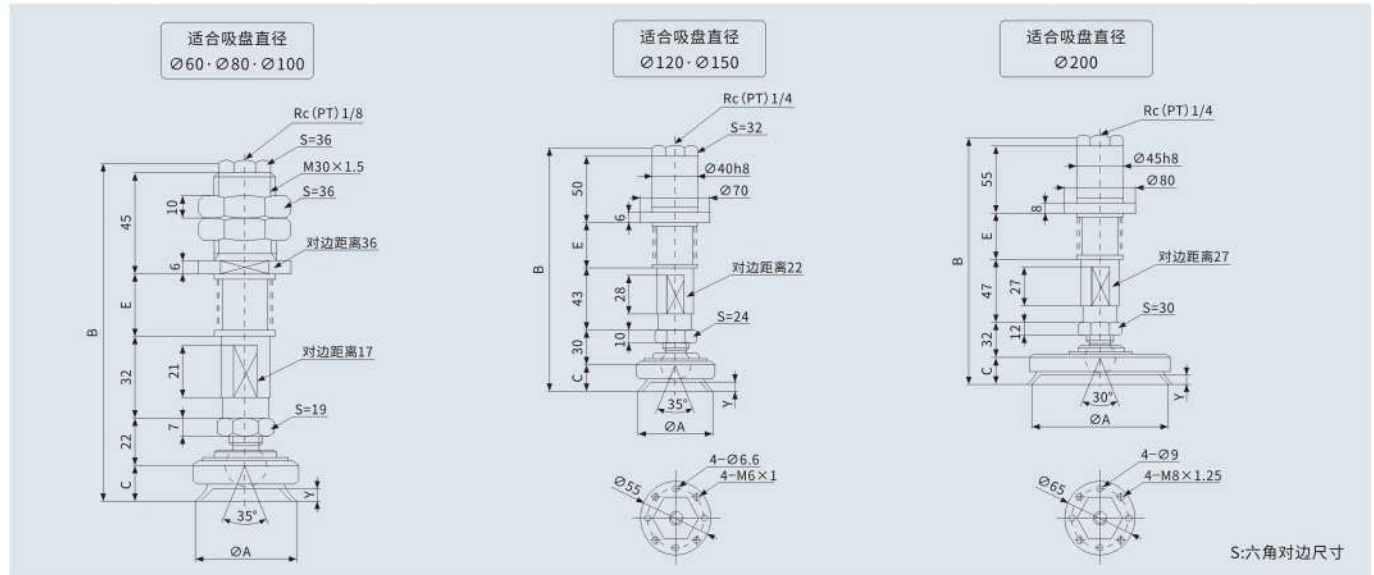

型号	A	B	C	E	Y
PUTSB-60-10	60	144	16	23	5.0
PUTSB-60-30	60	180	16	59	5.0
PUTSB-60-50	60	210	16	89	5.0
PUTSB-60-70	60	240	16	119	5.0
PUTSB-80-10	80	146	18	23	6.0
PUTSB-80-30	80	182	18	59	6.0
PUTSB-80-50	80	212	18	89	6.0
PUTSB-80-70	80	242	18	119	6.0
PUTSB-100-10	100	146	18	23	6.0
PUTSB-100-30	100	182	18	59	6.0
PUTSB-100-50	100	212	18	89	6.0
PUTSB-100-70	100	242	18	119	6.0
PUTSB-120-20	120	206	23	53.5	8.0
PUTSB-120-100	120	324	23	171.5	8.0
PUTSB-150-20	150	208	25	53.5	10.0
PUTSB-150-100	150	326	25	171.5	10.0
PUTSB-200-20	200	255	29	54	12.0
PUTSB-200-100	200	345	29	174	12.0



## 规格尺寸(mm)

水平方向连接

•PUYSB

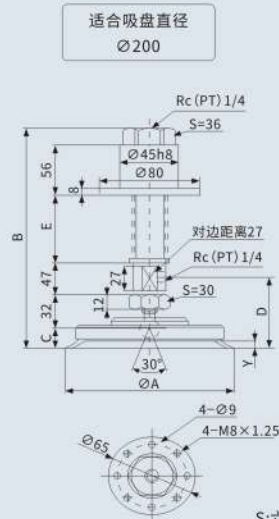
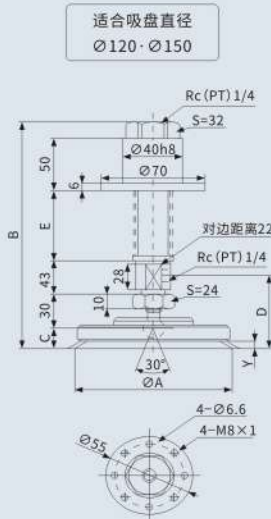
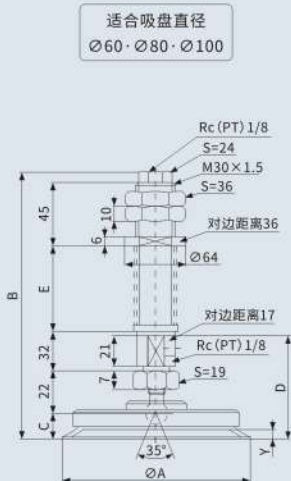
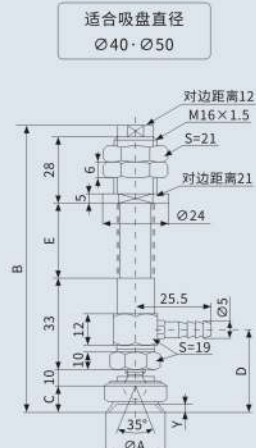
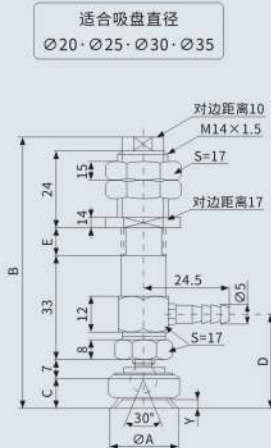
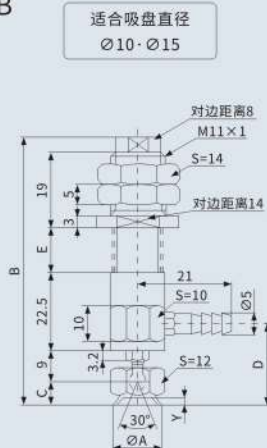

S:六角对边尺寸

型号	A	B	C	D	E	Y
PUYSB-10-4	10	66.5	5	22.5	8	1.0
PUYSB-10-10	10	78.5	5	22.5	20	1.0
PUYSB-10-20	10	98.5	5	22.5	40	1.0
PUYSB-10-30	10	118.5	5	22.5	60	1.0
PUYSB-15-4	15	67.5	6	23.5	8	1.4
PUYSB-15-10	15	79.5	6	23.5	20	1.4
PUYSB-15-20	15	99.5	6	23.5	40	1.4
PUYSB-15-30	15	119.5	6	23.5	60	1.4
PUYSB-20-6	20	90	9	33	13	2.0
PUYSB-20-15	20	107	9	33	30	2.0
PUYSB-20-30	20	137	9	33	60	2.0
PUYSB-20-50	20	177	9	33	100	2.0
PUYSB-25-6	25	90.5	9.5	33.5	13	2.5
PUYSB-25-15	25	107.5	9.5	33.5	30	2.5
PUYSB-25-30	25	137.5	9.5	33.5	60	2.5
PUYSB-25-50	25	177.5	9.5	33.5	100	2.5
PUYSB-30-6	30	91	10	34	13	2.0
PUYSB-30-15	30	108	10	34	30	2.0

# PUTSB/PUYSB系列

摇摆型吸盘附弹簧缓冲底座

型号	A	B	C	D	E	Y
PUYSB-30-30	30	138	10	34	60	2.0
PUYSB-30-50	30	178	10	34	100	2.0
PUYSB-35-6	35	92	11	35	13	3.0
PUYSB-35-15	35	109	11	35	30	3.0
PUYSB-35-30	35	139	11	35	60	3.0
PUYSB-35-50	35	179	11	35	100	3.0
PUYSB-40-6	40	104	11	41	13	3.0
PUYSB-40-15	40	121	11	41	30	3.0
PUYSB-40-30	40	151	11	41	60	3.0
PUYSB-40-50	40	191	11	41	100	3.0
PUYSB-50-6	50	105	12	42	13	4.0
PUYSB-50-15	50	122	12	42	30	4.0
PUYSB-50-30	50	152	12	42	60	4.0
PUYSB-50-50	50	192	12	42	100	4.0
PUYSB-60-10	60	144	16	58	23	5.0
PUYSB-60-30	60	180	16	58	59	5.0
PUYSB-60-50	60	210	16	58	89	5.0
PUYSB-60-70	60	240	16	58	119	5.0
PUYSB-80-10	80	146	18	60	23	5.0
PUYSB-80-30	80	182	18	60	59	6.0
PUYSB-80-50	80	212	18	60	89	6.0
PUYSB-80-70	80	242	18	60	119	6.0
PUYSB-100-10	100	146	18	60	23	6.0
PUYSB-100-30	100	182	18	60	59	6.0
PUYSB-100-50	100	212	18	60	89	6.0
PUYSB-100-70	100	242	18	60	119	6.0
PUYSB-120-20	120	206	23	82	53.5	8.0
PUYSB-120-100	120	324	23	82	171.5	8.0
PUYSB-150-20	150	208	25	84	53.5	10.0
PUYSB-150-100	150	326	25	84	171.5	10.0
PUYSB-200-20	200	255	29	94	54	12.0
PUYSB-200-100	200	345	29	94	174	12.0

吸盘及组件

HXD  
HOP  
HNP  
HNT  
SCG  
HXN  
HGP  
ZP  
ZP3  
ZP3E  
ZP3P  
ZP3P-JT3  
ZP3P-JT5  
MAF  
MAB  
MAOF  
MAOB  
BK  
PAG  
PATK/PAYK  
PATS  
PAYS  
PATKM/PAYKM  
PCG  
PCTK/PCYK  
PFG  
PFTK/PFYK  
PFTS  
PFYS  
PFTKM/PFYKM  
PJG  
PJTK/PJYK  
PJTS  
PJYS  
PJG  
PS  
PUG  
PUTK/PUYK  
PUTSB/PUYSB